



KÖSTER
Waterproofing Systems



KÖSTER System Overview

2025/2026

Content



// Fields of application for KÖSTER waterproofing

W	Waterproofing systems	3
M	Restoration of masonry	14
IN	Injection systems	18
C	Concrete repair and protection	24
SL	Self leveling underlayments	28
CT	Coatings	31
J	Joint sealing	36
B	Bathroom and wet rooms	38
P	Façade protection and paints	39
R	Roofing	40

// Products

PL	Product list	44
-----------	--------------	----

External basement waterproofing

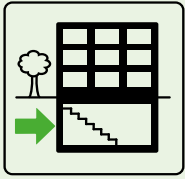

Wet basements cannot be fully used and might endanger the building substance. We offer different methods for making basements permanently waterproof: From the outside with polymer-modified thick film sealants, mineral sealing slurries or a cold self-adhesive waterproofing membrane – whereby the entire external wall area is treated and thus protected from water penetration. In repair cases, the external waterproofing can be installed even from the inside of the basement. This method is called “curtain injection”.

External basement waterproofing with bitumen based waterproofing systems

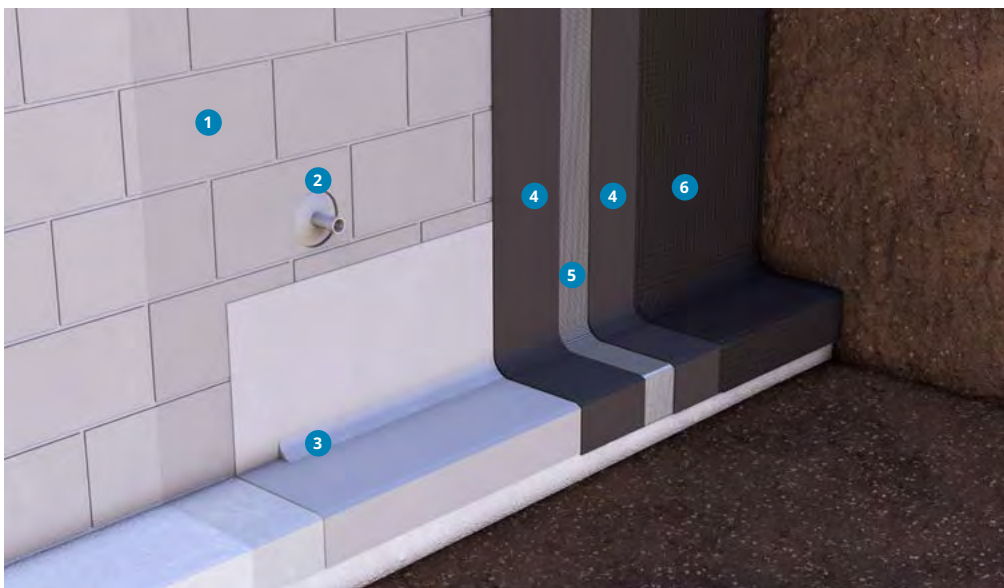

- 1 **Primer**
KÖSTER Polysil TG 500
- 2 **Waterproofing pipe penetrations**
KÖSTER KB-Flex 200
- 3 **Installing fillets**
KÖSTER WP Mortar
- 4 **Waterproofing layer**
KÖSTER Deuxan 2C
- 5 **Reinforcement**
KÖSTER Glass Fiber Mesh
- 6 **Protection of the waterproofing layer**
KÖSTER SD
Protection and Drainage
Sheet 3-250

External basement waterproofing with mineral based waterproofing systems



- 1 **Primer**
KÖSTER Polysil TG 500
- 2 **Waterproofing pipe penetrations**
KÖSTER KB-Flex 200
- 3 **Installing fillets**
KÖSTER WP Mortar
- 4 **Waterproofing layer**
KÖSTER NB 4000
- 5 **Reinforcement**
KÖSTER Glass Fiber Mesh
- 6 **Protection of the waterproofing layer**
KÖSTER SD
Protection and Drainage
Sheet 3-250

External basement waterproofing with thermoplastic waterproofing membranes

- 1 Waterproofing membrane
KÖSTER TPO 1.5 Pro UG S
- 2 Protection of the waterproofing layer
KÖSTER SD
Protection and Drainage
Sheet 3-250
- 3 Wall connection
KÖSTER Wall connection
profile
- 4 Joint Sealing
KÖSTER MS Joint Sealant



Waterproofing under the foundation plate

- 1 Primer
KÖSTER Polysil TG 500
- 2 Waterproofing layer
KÖSTER NB 4000
Alternative:
KÖSTER KSK SY 15
KÖSTER TPO 1.5 Pro UG S
- 3 Embedded mesh
KÖSTER Glass Fiber Mesh
- 4 Gliding Layer
Customary PE-foil
- 5 Fillet
KÖSTER WP Mortar
- 6 Protection of the waterproofing layer
KÖSTER SD
Protection and Drainage
Sheet 3-250



External basement waterproofing with cold self-adhesive waterproofing membranes

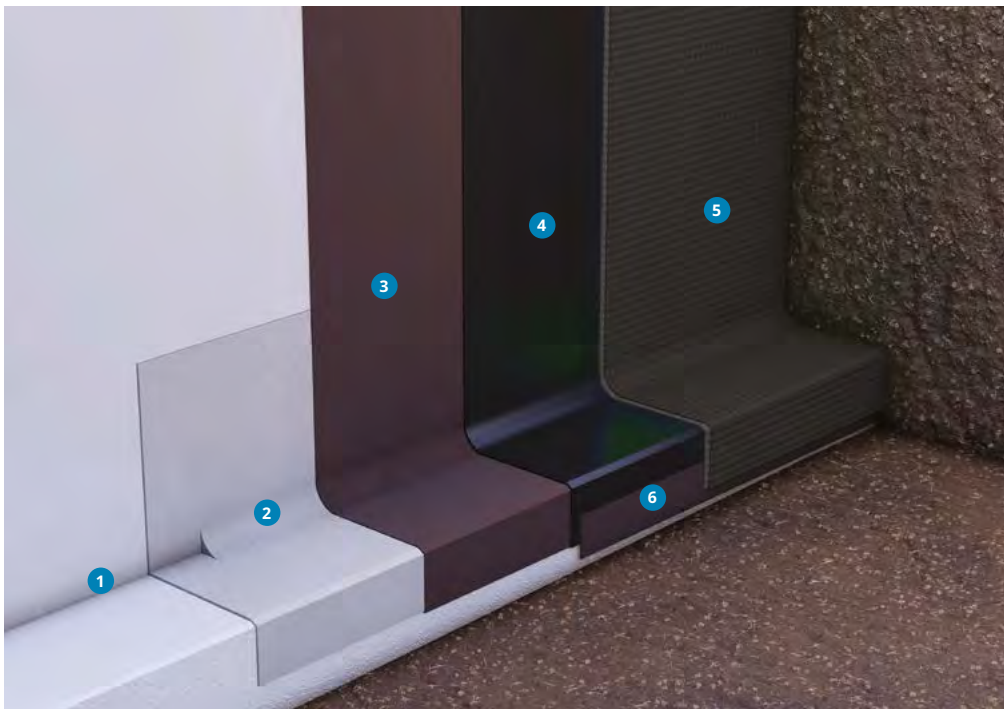

- 1 Joint sealing
KÖSTER Quellband
- 2 Installing fillets
KÖSTER WP Mortar
- 3 Primer
KÖSTER KBE Liquid Film
- 4 Waterproofing layer
KÖSTER KSK SY 15
- 5 Protection of the waterproofing layer
KÖSTER SD
Protection and Drainage
Sheet 3-250
- 6 Waterproofing membrane
ending
KÖSTER KBE Liquid Film

Waterproofing of pile heads

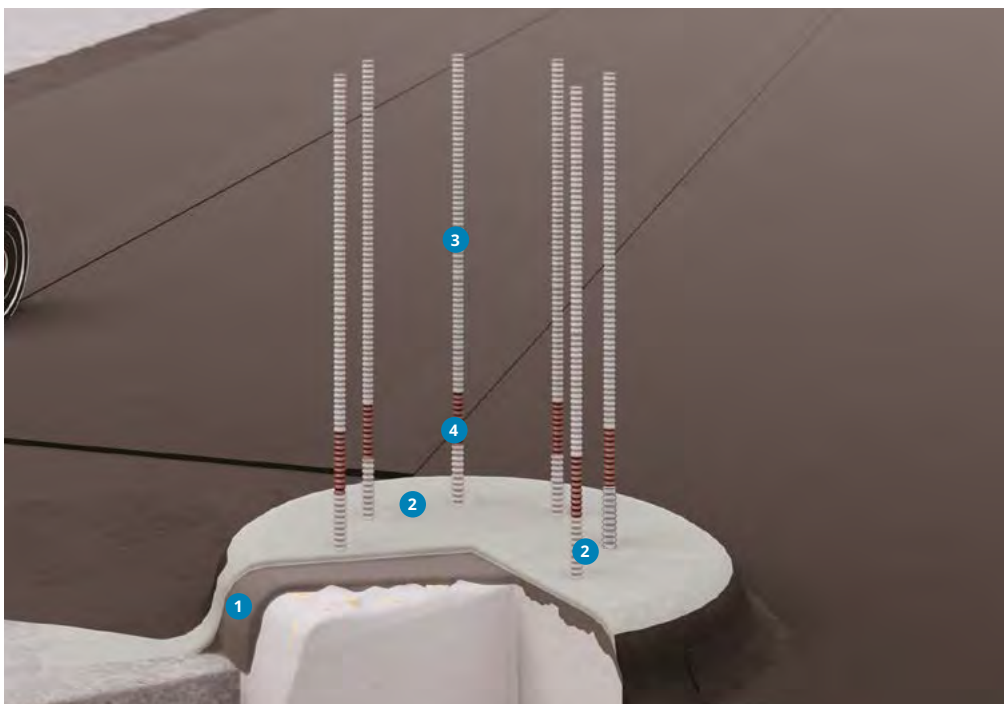

- 1 Reprofilung
KÖSTER Repair Mortar R4
- 2 Waterproofing of pile
heads
KÖSTER NB 1 Grey
- 3 Corrosion protection
KÖSTER Z1
- 4 Corrosion protection
KÖSTER Z2

Internal basement waterproofing

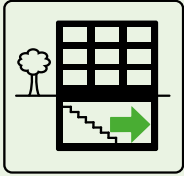

In a repair situation, the basement can be waterproofed from the inside without excavating the soil around the building. This means that the basement is permanently waterproofed without the necessity of doing any sort of earthwork. This type of waterproofing is possible with the KÖSTER systems even when the wall has active leakages.

Internal basement waterproofing on the foundation plate with cold-adhesive waterproofing membranes

- 1 Horizontal barriers for walls
KÖSTER Fix-Tape 15 SY
- 2 Primer
KÖSTER KSK Primer BL
- 3 Waterproofing Layer
KÖSTER KSK SY 15
- 4 Edge Waterproofing
KÖSTER Butyl Fix-Tape Fleece
- 5 Protection layer (PE foil)
- 6 Waterproofing pipe penetrations
KÖSTER KB-Flex 200



- 1 Stopping active leakages
KÖSTER KD 2 Blitz Powder
- 2 Primer
KÖSTER Polysil TG 500
- 3 Levelling the surface
KÖSTER WP Mortar
- 4 Installing fillets
KÖSTER WP Mortar
- 5 Waterproofing layer
KÖSTER KD System
- 6 Plaster key
KÖSTER Restoration Plaster Key
- 7 Plaster
KÖSTER Restoration Plaster White
- 8 Fine Finish
KÖSTER Fine Plaster
- 9 Paint
KÖSTER Renovation Paint White

Internal basement waterproofing in case of flowing water and in case of ground moisture, non-pressurized, and pressurized water

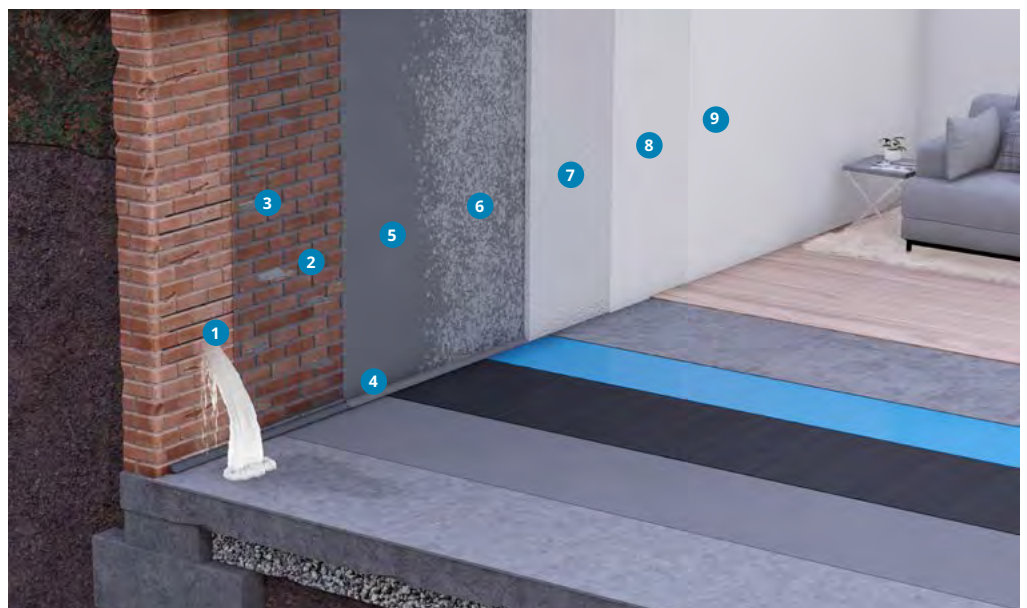

Internal basement waterproofing on foundation plate with mineral systems

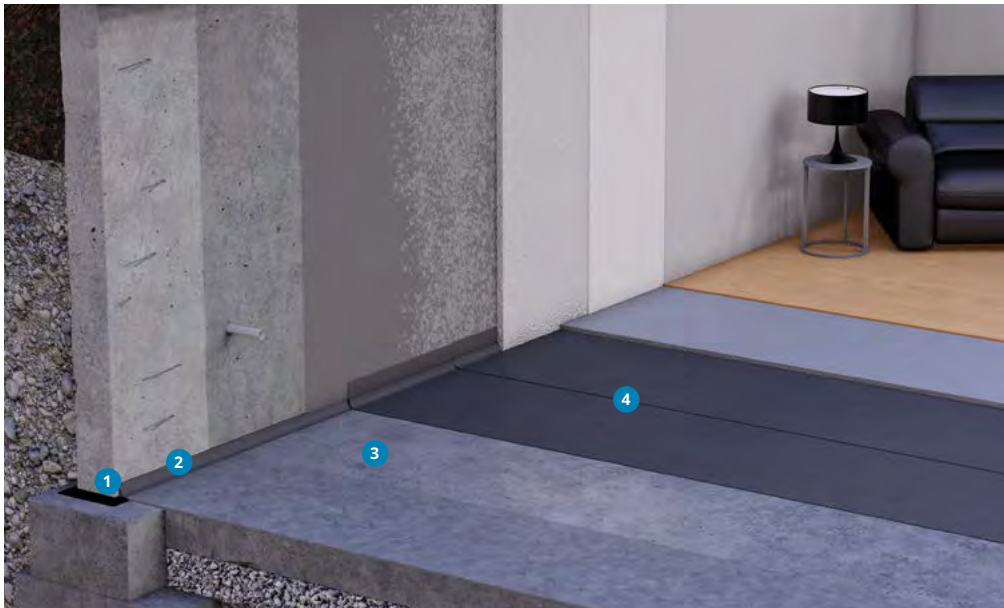

- 1 Horizontal barriers for walls
KÖSTER NB 4000
- 2 Installing fillets
KÖSTER WP Mortar
- 3 Primer
KÖSTER Polysil TG 500
- 4 Waterproofing layer
KÖSTER NB 4000

Tunnel waterproofing and restoration

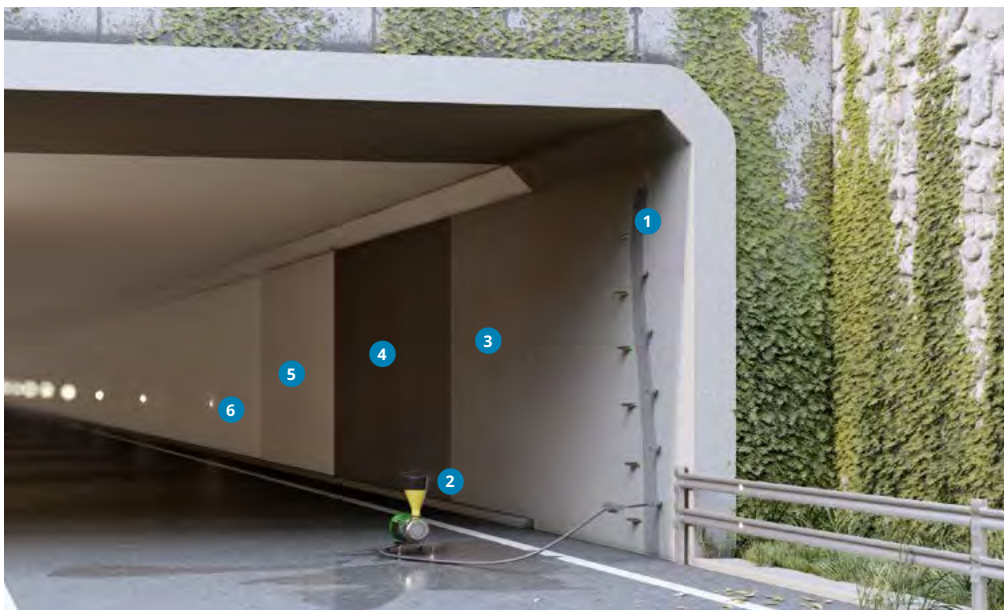

- 1 Crack injection
KÖSTER 2 IN 1
- 2 Pump
KÖSTER 1C Injection Pump
- 3 Primer
KÖSTER Polysil TG 500
- 4 Waterproofing layer
KÖSTER NB 1 Grey
- 5 Surface levelling
KÖSTER C-Coat
- 6 Paint
KÖSTER Renovation Paint White

Waterproofing balconies and terraces

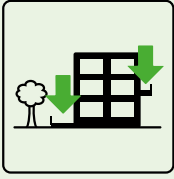

This field poses the highest demands on waterproofing. It must be able to resist the weather, be waterproof and provide a certain structural stability. Also, outside the movements of the construction members are usually comparably large, so that it is necessary to use waterproofing systems with high crack bridging capabilities.

Waterproofing of balconies and terraces with mineral based waterproofing systems

- 1 **Concrete repair**
KÖSTER Betomor Multi A
- 2 **Primer**
KÖSTER Polysil TG 500
- 3 **Waterproofing Layer**
KÖSTER NB 4000
Alternative:
KÖSTER NB Elastic Grey
- 4 **Reinforcement**
KÖSTER Glass Fiber Mesh
- 5 **Tile Adhesive**
KÖSTER BD Flexible Tile Adhesive
- 6 **Tiles**



Waterproofing of balconies and terraces with TPO membranes

- 1 **Concrete Repair**
KÖSTER Betomor Multi A
- 2 **Separation layer**
- 3 **Waterproofing Layer**
KÖSTER TPO
- 4 **Terrace covering on pedestals**



Waterproofing of small flat and sloped roofs

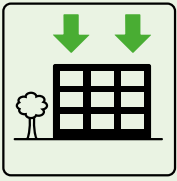

Flatly sloped roofs or smaller pitched roofs must be protected or strengthened against the effects of the weather. The mineral flat roof coating is ideal for a simple and safe revision and refreshment of the existing waterproofing. It is easy to process and offers high-quality, long-lasting protection.

Roof waterproofing with mineral based liquid membrane



- 1 Concrete Repair**
KÖSTER Betomor Multi A
- 2 Primer**
KÖSTER Polysil TG 500
- 3 Installing fillets**
KÖSTER WP Mortar
- 4 Waterproofing wall / floor junctions**
KÖSTER Superfleece
- 5 Waterproofing layer**
KÖSTER 21
- 6 Reinforcement**
KÖSTER Flex Fabric

Waterproofing potable water tanks

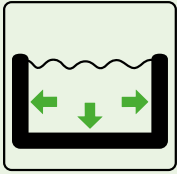

Waterproofing for drinking water storage structures and tanks must not only remain watertight for many years, but must also meet all sanitary requirements. The system used should be free of development of micro-organisms on the surface and at the same time, allow an easy and periodical cleaning method, with non-harmful substances.

Waterproofing water tanks with TPO membranes

- 1 Substructure
- 2 KÖSTER TPO Membrane
KÖSTER TPO Aqua 1.5

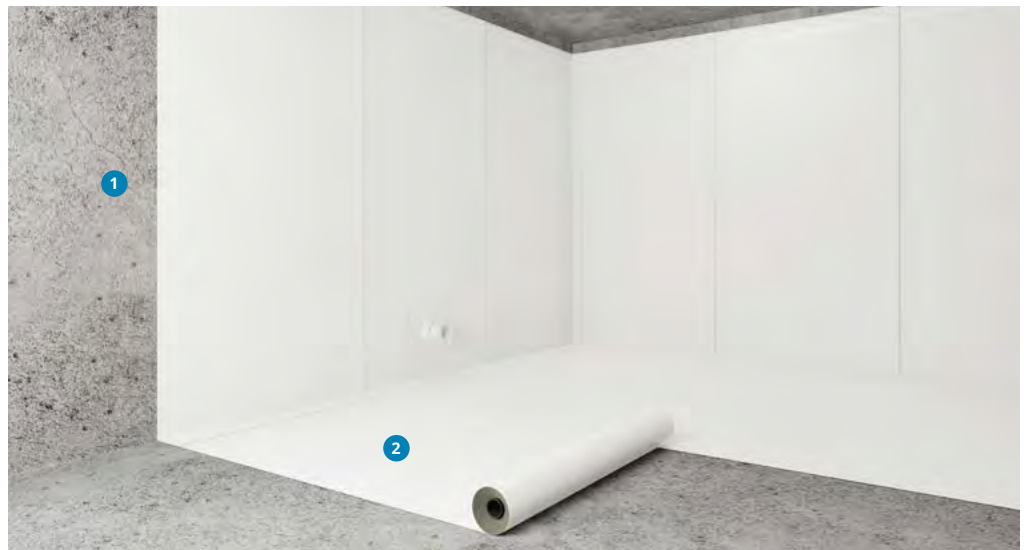

Waterproofing water tanks with 1 component crystalizing mineral coat

- 1 Concrete Repair
KÖSTER Repair Mortar R4
- 2 Primer
KÖSTER Polysil TG 500
- 3 Installing fillets
KÖSTER WP Mortar
- 4 Waterproofing layer
KÖSTER NB 1 Grey

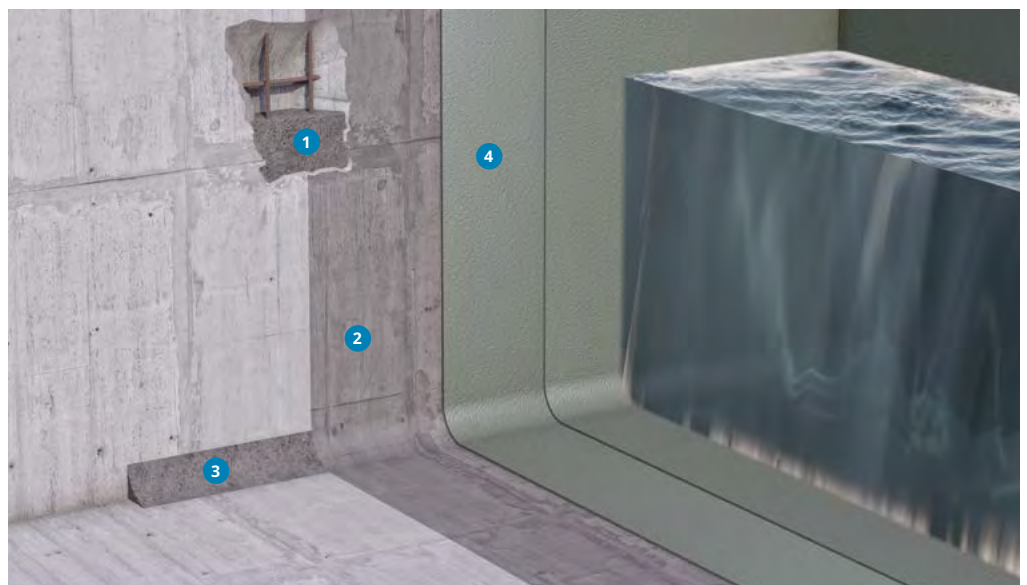

Waterproofing water tanks with 2 component elastic mineral coat (except for potable water tanks)

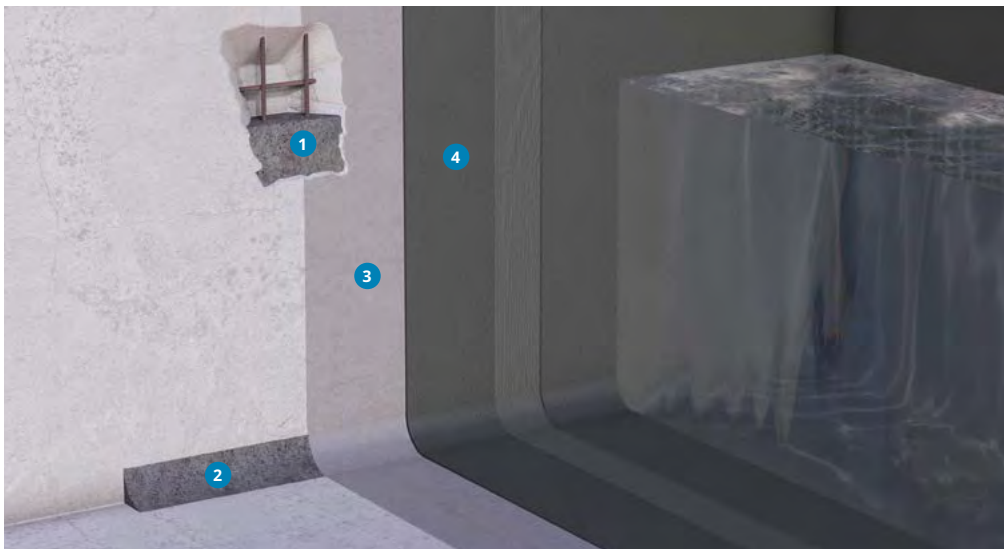

- 1 Concrete Repair
KÖSTER Repair Mortar R4
- 2 Installing fillets
KÖSTER WP Mortar
- 3 Primer
KÖSTER Polysil TG 500
- 4 Waterproofing layer
KÖSTER NB 4000

Waterproofing swimming pools

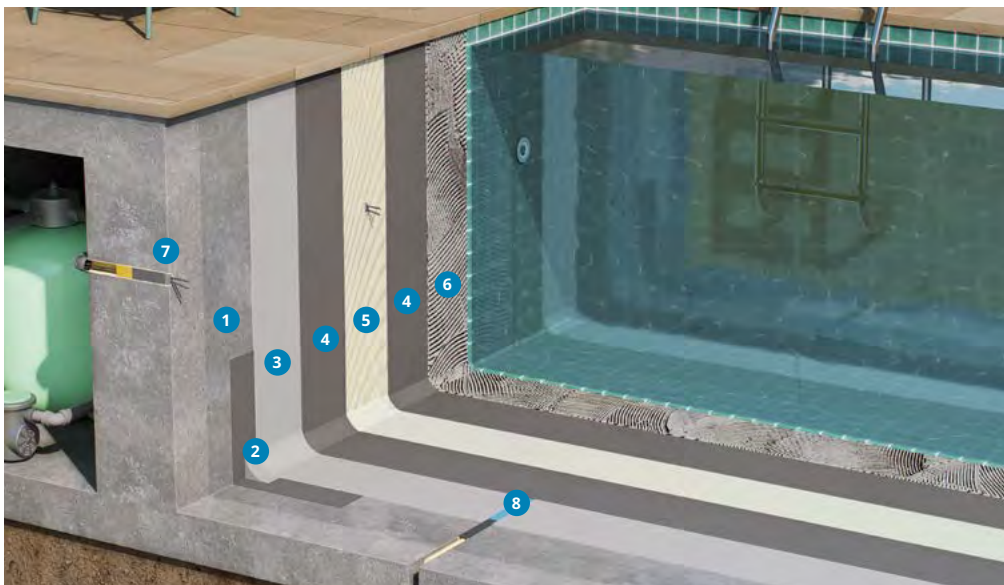

- 1 Primer
KÖSTER Polysil TG 500
- 2 Fillet
KÖSTER WP Mortar
- 3 Negative side waterproofing
KÖSTER NB 1 Grey
- 4 Positive side waterproofing
KÖSTER NB 4000
- 5 Reinforcement
KÖSTER Glass Fiber Mesh
- 6 Tile adhesive
KÖSTER BD
Flexible Tile Adhesive
- 7 Penetrations
KÖSTER KB-Flex 200
- 8 Joint sealing
KÖSTER Joint Sealant FS

Waterproofing of pipes, manholes and sewage systems

- 1 Stopping active leakages
KÖSTER KD 2 Blitz Powder
- 2 Repair
KÖSTER Repair Mortar NC
- 3 Waterproofing
KÖSTER NB 1 Grey
Alternative:
KÖSTER NB 1 Flex
- 4 Acid protection
KÖSTER PSM
- 5 Waterproofing shafts
KÖSTER Sewer
and Shaft Mortar
- 6 Waterproofing pipe
couplings
KÖSTER Injection Gel G4
- 7 Crack injection
KÖSTER 2 IN 1
- 8 Heavy duty surface
protection
KÖSTER Sewer
and Shaft Mortar



Dams and Canals

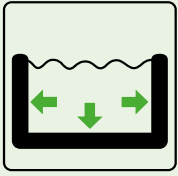

A hydraulic structure is a man-made structure submerged or partially submerged which disrupts the natural flow of water in order to use it for other purposes, such as energy production, storage and even protection (against flooding). These structures are commonly known as dams.

Other types of man-made structures that deal with big quantities of water are canals and artificial lakes, that are mostly used for storage and irrigation purposes for agriculture and drinking water transport, but also for hydropower production.

Waterproofing dams



1 Substrate

2 Waterproofing layer

KÖSTER TPO Aqua 2.5 Geo

Waterproofing canals

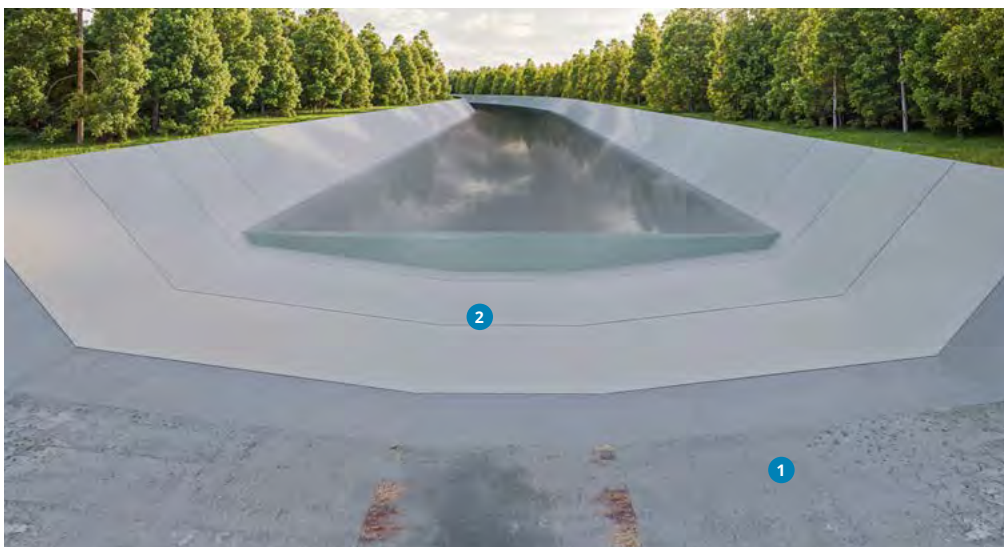

1 Substructure

2 Waterproofing layer

KÖSTER TPO Aqua 2.5 Geo

Horizontal barriers for restoration walls

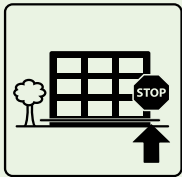

Rising moisture in masonry over a longer period of time can lead to considerable damages. An indication of these damages is salt efflorescence, flaking plaster, moist wallpaper and the formation of mold which can be harmful. KÖSTER horizontal barriers stop rising moisture in new construction and existing buildings to protect the valuable building substance.

- 1 **Accessories**
KÖSTER Capillary Rods
- 2 **Accessories**
KÖSTER Suction Angle
- 3 **Cross section waterproofing**
KÖSTER Crisin 76
- 4 **Primer**
KÖSTER Polysil TG 500
- 5 **Levelling**
KÖSTER WP Mortar
- 6 **Waterproofing layer**
KÖSTER NB 1 Grey
- 7 **Plaster key**
KÖSTER Restoration Plaster Key
- 8 **Plaster**
KÖSTER Restoration Plasters
- 9 **Fine plaster**
KÖSTER Fine Plaster
- 10 **Paint**
KÖSTER Renovation Paint White

Horizontal barriers with pressureless injection system KÖSTER Crisin 76

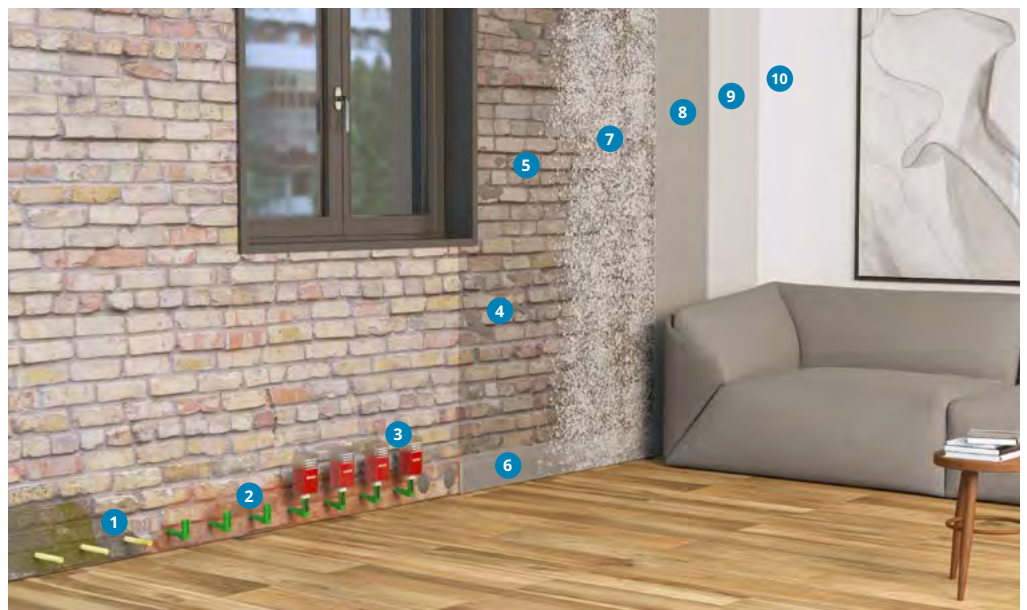

Horizontal barriers with pressureless injection system KÖSTER Crisin Cream

- 1 **Cross section waterproofing**
KÖSTER Crisin Cream
- 2 **Closing holes**
KÖSTER KB-Fix 5
- 3 **Primer**
KÖSTER Polysil TG 500
- 4 **Levelling**
KÖSTER Repair Mortar
- 5 **Waterproofing layer**
KÖSTER NB 1 Grey
- 6 **Plaster key**
KÖSTER Restoration Plaster Key
- 7 **Plaster**
KÖSTER Restoration Plasters
- 8 **Fine plaster**
KÖSTER Fine Plaster
- 9 **Paint**
KÖSTER Renovation Paint White

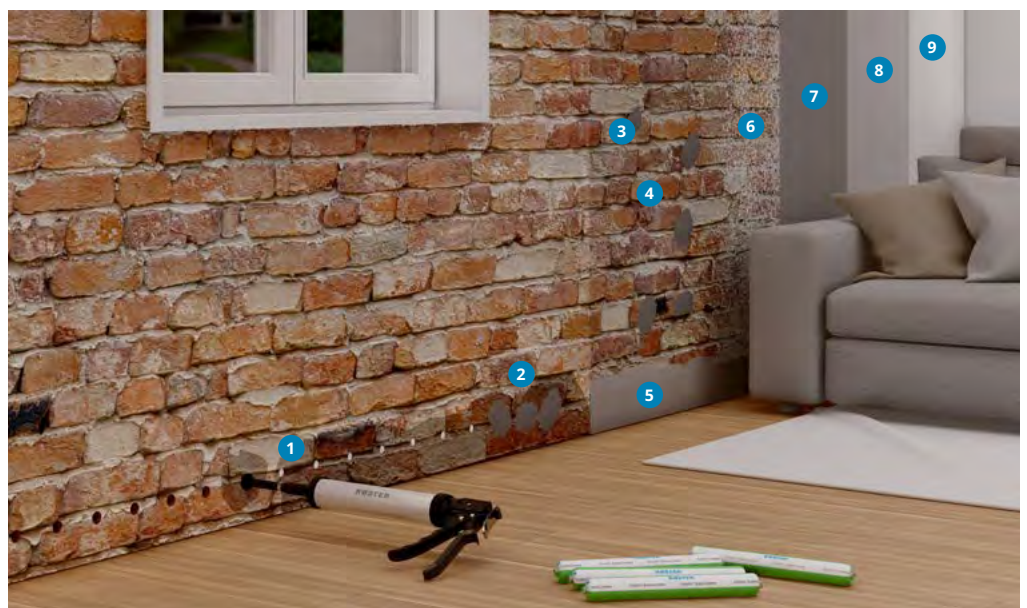

Horizontal barriers with pressure injection for voidless masonry

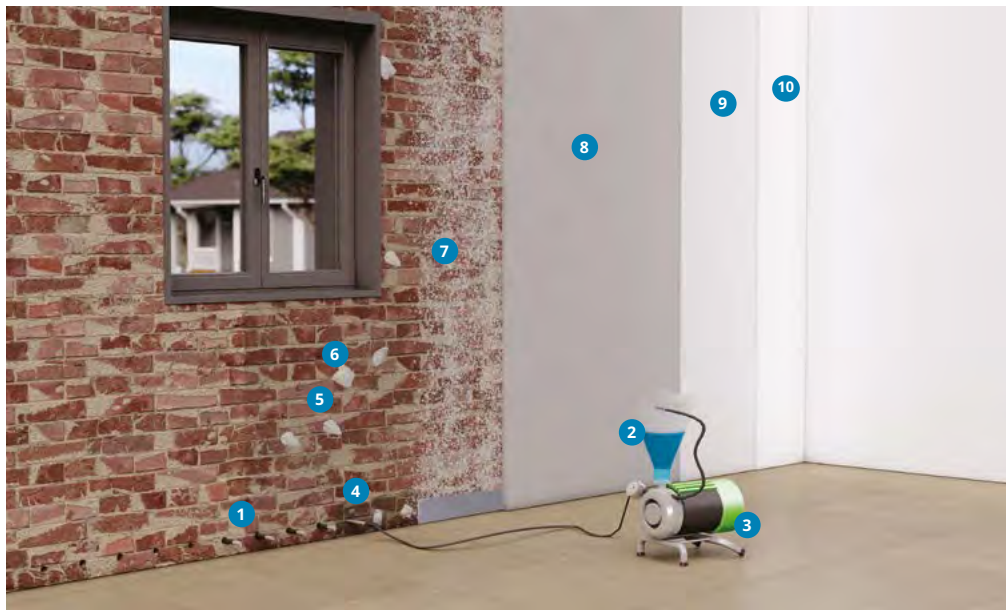

- 1 Installing the packers
KÖSTER Superpacker
10 mm x 85 mm CH
- 2 Installing the horizontal
barrier via injection
KÖSTER Mautrol Flex 2C
- 3 Pump
KÖSTER 1C Injection Pump
- 4 Closing holes
KÖSTER KB-Fix 5
- 5 Primer
KÖSTER Polysil TG 500
- 6 Levelling
KÖSTER Repair Mortar
- 7 Plaster key
KÖSTER Restoration
Plaster Key
- 8 Plaster
KÖSTER Restoration
Plasters
- 9 Fine plaster
KÖSTER Fine Plaster
- 10 Paint
KÖSTER Renovation Paint
White

Horizontal barriers with self adhesive tape (New Construction)



- 1 Horizontal barriers for
walls
KÖSTER KSK SY 15

Horizontal barriers with mineral systems (New Construction)



- 1 Horizontal barriers for
Waterproofing Layer
KÖSTER NB 4000
- 2 Installing fillets
KÖSTER WP Mortar

Systems against possible mold growth



Mold in living areas caused by moisture penetration and thermal bridges results in extensive health damage because the mold releases its spores into the air which is then inhaled by the inhabitants. A special Anti Mold System – which functions on a purely physical basis and which is free of fungicidal toxins provides a permanent protection because mold can not grow on this coating.

Restoration of masonry with restoration plasters

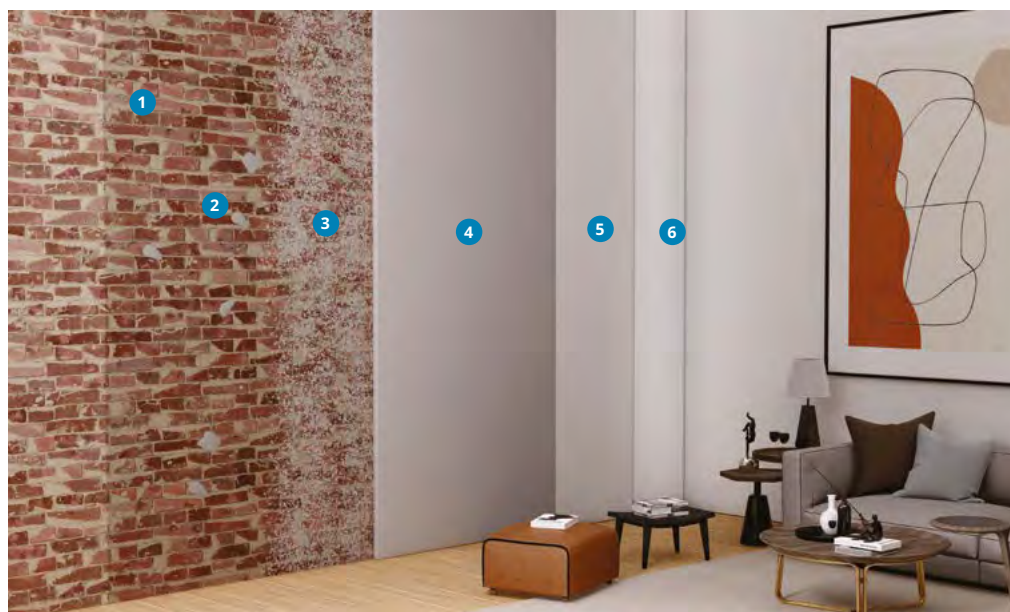

- 1 **Primer**
KÖSTER Polysil TG 500
- 2 **Levelling**
KÖSTER Repair Mortar
- 3 **Plaster key**
KÖSTER Restoration Plaster Key
- 4 **Plaster**
KÖSTER Restoration Plasters
- 5 **Fine plaster**
KÖSTER Fine Plaster
- 6 **Paint**
KÖSTER Renovation Paint White

Improve indoor climate with KÖSTER Thermal Restoration Plaster

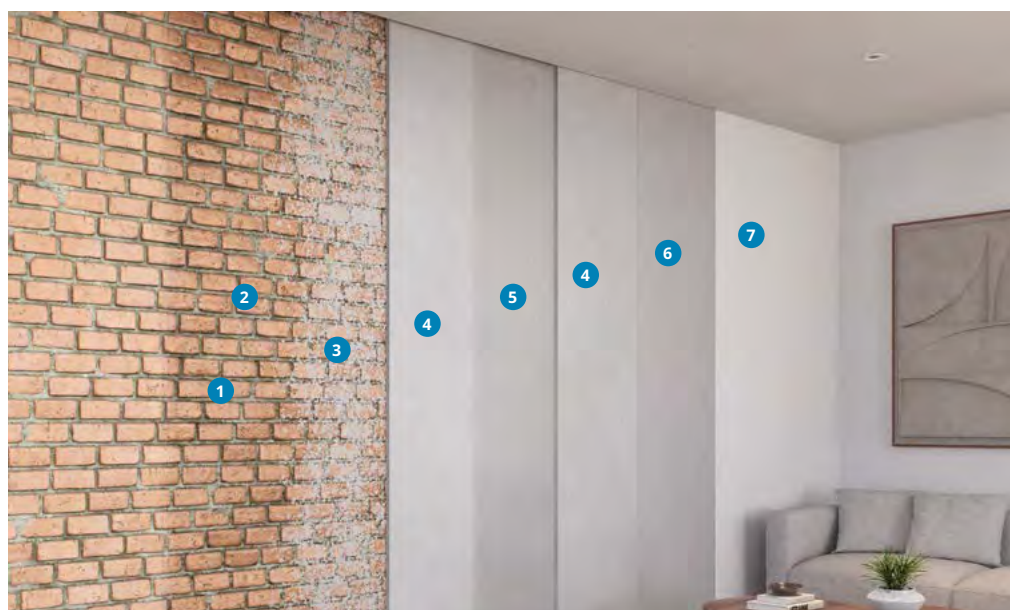

- 1 **Primer**
KÖSTER Polysil TG 500
- 2 **Levelling**
KÖSTER Repair Mortar
- 3 **Plaster key**
KÖSTER Restoration Plaster Key
- 4 **Plaster**
KÖSTER Thermal Restoration Plaster
- 5 **Reinforcement**
KÖSTER Glass Fiber Mesh
- 6 **Optional surface treatment**
KÖSTER Hydrosilicate Adhesive SK
- 7 **Paint**
KÖSTER Renovation Paint White

Hydrosilicate system for mold remediation and prevention on interior surfaces

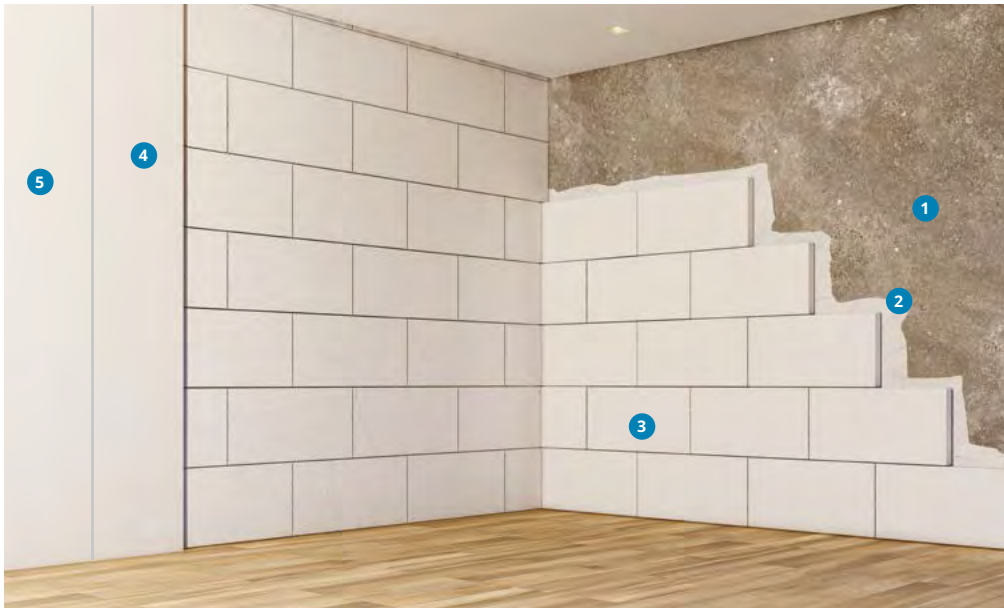

- 1 **Surface preparation**
KÖSTER Polysil TG 500
- 2 **Adhesive**
KÖSTER Hydrosilicate Adhesive SK
- 3 **Boards**
KÖSTER Hydrosilicate Board
- 4 **Fine plaster**
KÖSTER Hydrosilicate Adhesive SK
- 5 **Paint**
KÖSTER Renovation Paint White

Crack injection and hose injection

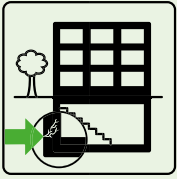

Cracks in the building substance are structurally weak points. Additionally, penetrating water may cause damage and may reduce the usage and lifetime of the building. An elastic sealing or structural-bonding of the crack is required. In order to achieve this, the crack is filled over its entire course with a polyurethane or epoxy injection resin via pressure injection.

Elastic and structural crack injection by pressure injection on dry or wet cracks

Elastic crack sealing

- 1 Injection packer
KÖSTER Injection Packers
- 2 Injection material
KÖSTER 2 IN 1
- 3 Pump
KÖSTER
1C Injection Pump

Rigid, structural crack injection

- 4 Installing the packers
KÖSTER Lamella packer
- 5 Injection material
KÖSTER Micro Grout 1C
- 6 Pump
KÖSTER Loka Handpump



Pressure injection of water bearing cracks

- 1 Injection packer
KÖSTER Injection Packers
- 2 Injection Resin
KÖSTER 2 IN 1
Alternative:
KÖSTER IN 8
- 3 Pump
KÖSTER 1C Injection Pump



Waterproofing of construction joints in the wall/floor junction

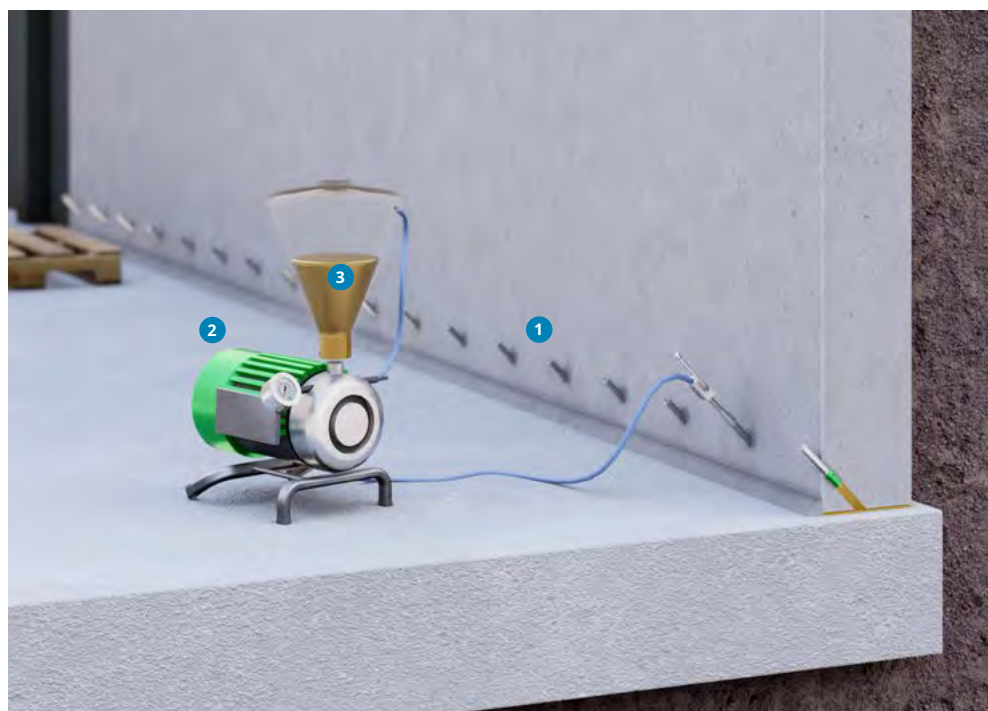

- 1 Injection packer
KÖSTER Injection Packers
- 2 Pump
KÖSTER 1C Injection Pump
- 3 Injection Resin
KÖSTER 2 IN 1
Alternative:
KÖSTER IN 5

Waterproofing of construction joints via an injection hose



- 1 Injection hose
- 2 Injection Resin
KÖSTER IN 5
- 3 Pump
KÖSTER 1C Injection Pump

Acrylic gel injections

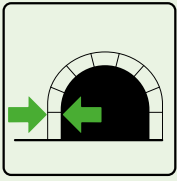

Acrylic gels are predominantly distinguished by their extremely low initial viscosity (similar to water), allowing the deepest penetration in the pore structure among all other injection materials. They are typically used for building waterproofing through curtain, masonry, and void injection. Tunnel waterproofing requires specialized waterproofing materials which can vary depending on the type of tunnel elements and construction methods involved. Special parameters such as abnormally high water pressure and infrastructure conditions must be taken into consideration during restoration planning. Acrylic gels used for building waterproofing are characterized, even in the fully reacted state, by having considerable amounts of water (hydrophilic capabilities), which is physically bound in the polymer network. The binding is sufficient that the water cannot be driven out even by high pressure.

Tubing Tunnel Construction

- ① Injection needle
KÖSTER Injection Gel G4
- ② Curtain injection
KÖSTER Injection Gel G4
- ③ Gel pump
KÖSTER Acrylic Gel Pump



Masonry Tunnel Construction

- ① Area injection
KÖSTER Injection Gel G4
- ② Injection packer
KÖSTER Injecton Packers
- ③ Injection pump
KÖSTER Acrylic Gel Pump
- ④ Void filling
KÖSTER Injection Gel G4



Joint Sealing in Tunnel Constructions with injections



- 1 Pump
KÖSTER Acrylic Gel Pump
- 2 Special rubber sealing system
- 3 Injection needle
- 4 Joint sealant
KÖSTER Injection Gel S4
- 5 Joint protection
KÖSTER MS Joint Sealant

Injection of expansion joints



- 1 Injection packer
KÖSTER Injecton Packers
- 2 Joint waterproofing
KÖSTER Injection Gel S4

External basement waterproofing with curtain injection

- 1 Pump
KÖSTER Acrylic Gel Pump
- 2 Injection packers
KÖSTER Injection Packers
- 3 Waterproofing layer
KÖSTER Injection Gel G4



Vertical and horizontal curtain injection

- 1 Pump
KÖSTER Acrylic Gel Pump
- 2 Injection packers
KÖSTER Superpacker
- 3 Waterproofing layer
KÖSTER Injection Gel G4

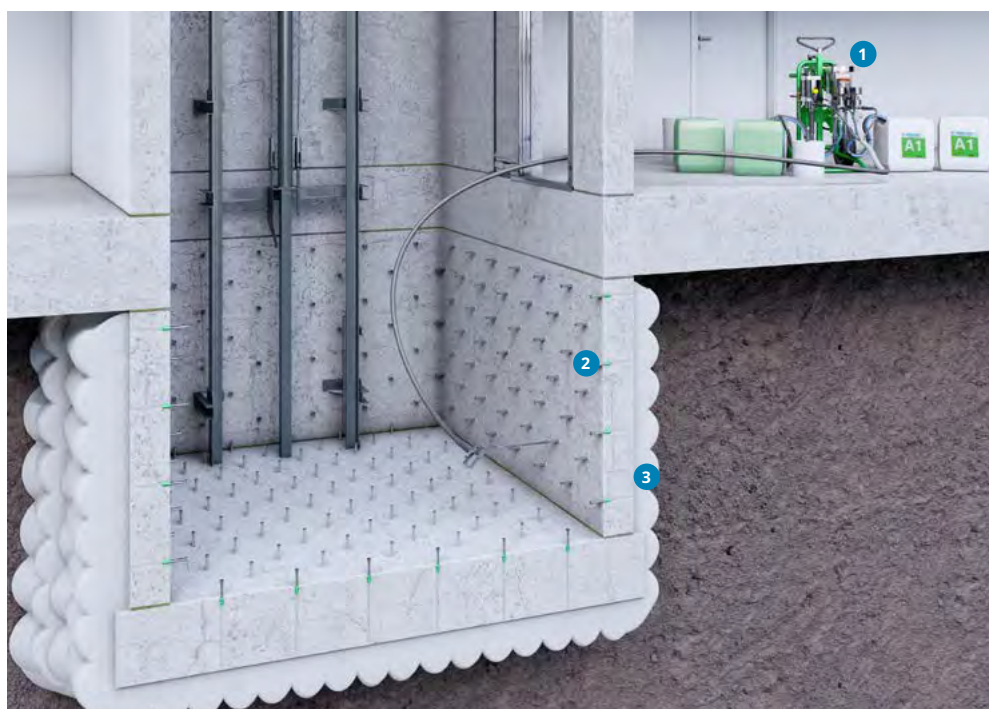

Masonry injection

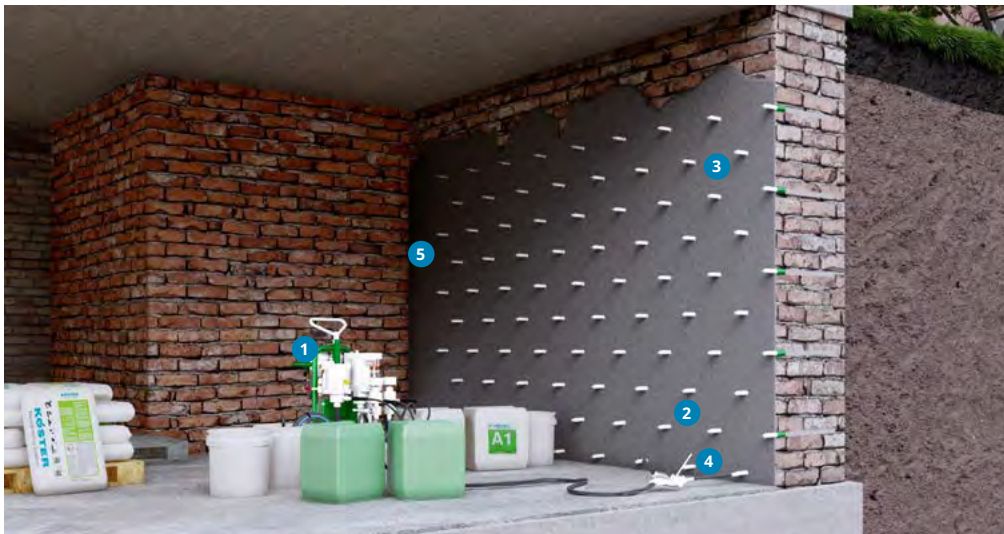

- 1 Pump
KÖSTER Acrylic Gel Pump
- 2 Injection Barrier
KÖSTER Injection Barrier
- 3 Injection packers
KÖSTER Injection Packers
- 4 Waterproofing layer
KÖSTER Injection Gel G4
- 5 Filling the boreholes
KÖSTER KB-Fix 5

Concrete injection

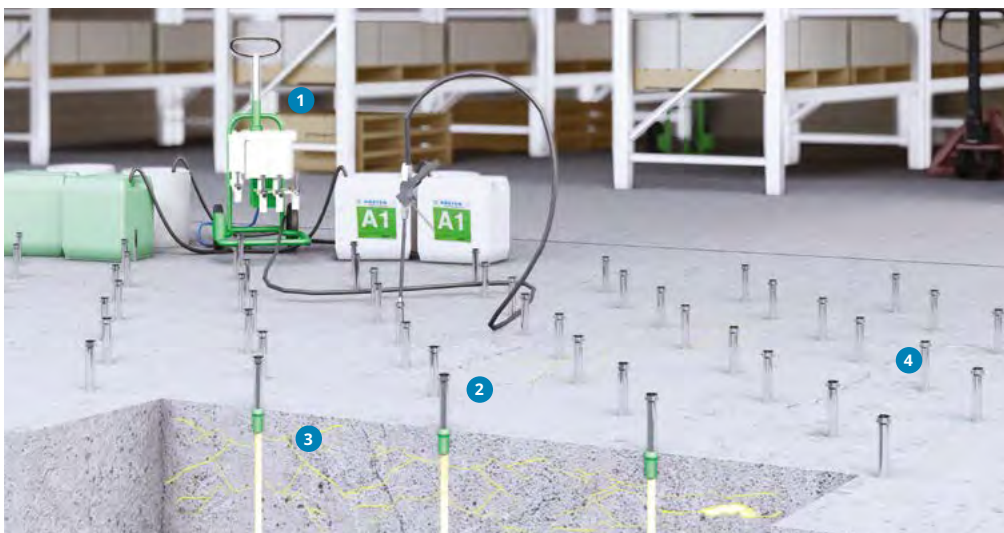

- 1 Pump
KÖSTER Acrylic Gel Pump
- 2 Injection packers
KÖSTER One-Day-Site
- 3 Waterproofing layer
KÖSTER Injection Gel G4
- 4 Filling the boreholes
KÖSTER KB-Fix 5

Soil stabilization



- 1 Pump
KÖSTER Acrylic Gel Pump
- 2 Injection lances
- 3 Injection and stabilization layer
KÖSTER Injection Gel G4

Concrete Repair Systems

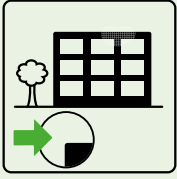

Damages to construction members made of concrete require treatment in order to restore the original characteristics. Exposed steel reinforcement must also be protected from corrosion.

The original structure is restored using mineral products, that recover not only the functionality of the structures, but also protect them from further corrosion and the carbonation process.

Small Areas

- 1 Concrete Repair
KÖSTER Betomor Multi A

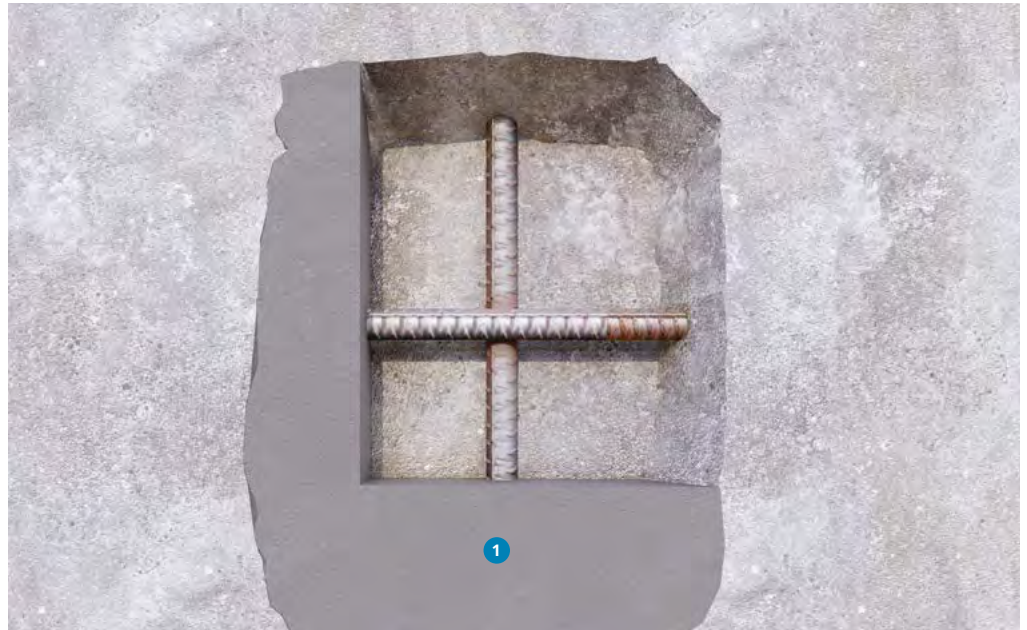

Large Areas

- 1 Corrosion protection (reinforcement)
KÖSTER Z 1
KÖSTER Z 2
- 2 Concrete repair
KÖSTER Repair Mortar R4
- 3 Surface levelling and smoothing
KÖSTER C-Coat

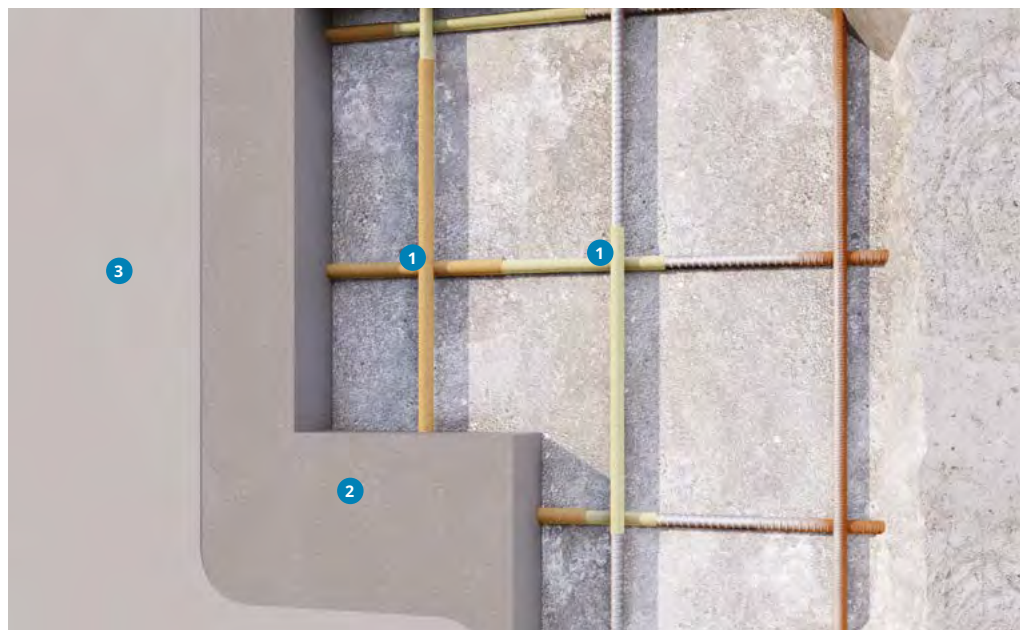

Large Areas (spray application)



1 Corrosion protection (reinforcement)

KÖSTER Z1
KÖSTER Z2

2 Concrete repair

KÖSTER Repair Mortar NC

Rough Surface renovation

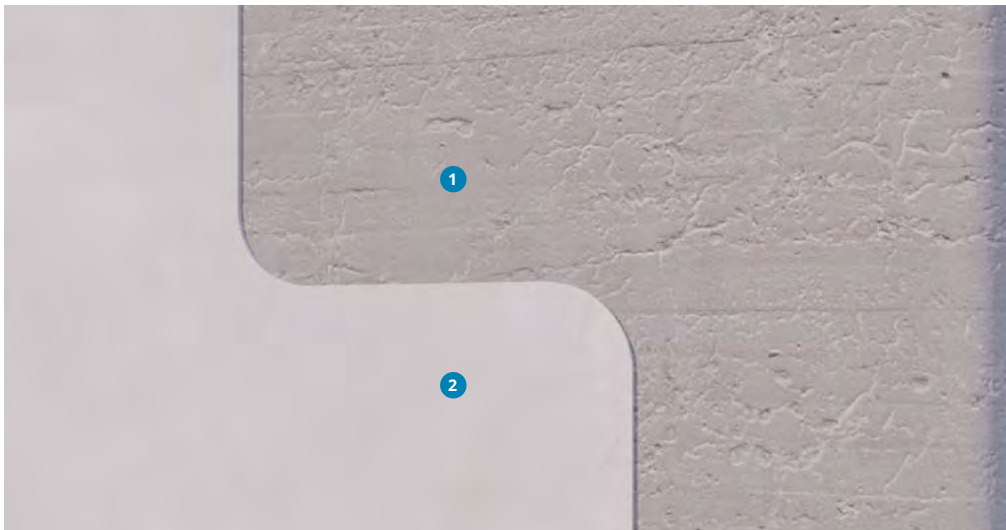

1 Rough concrete

2 Surface levelling and smoothing

KÖSTER C-Coat

High early strength mortar systems (1h)

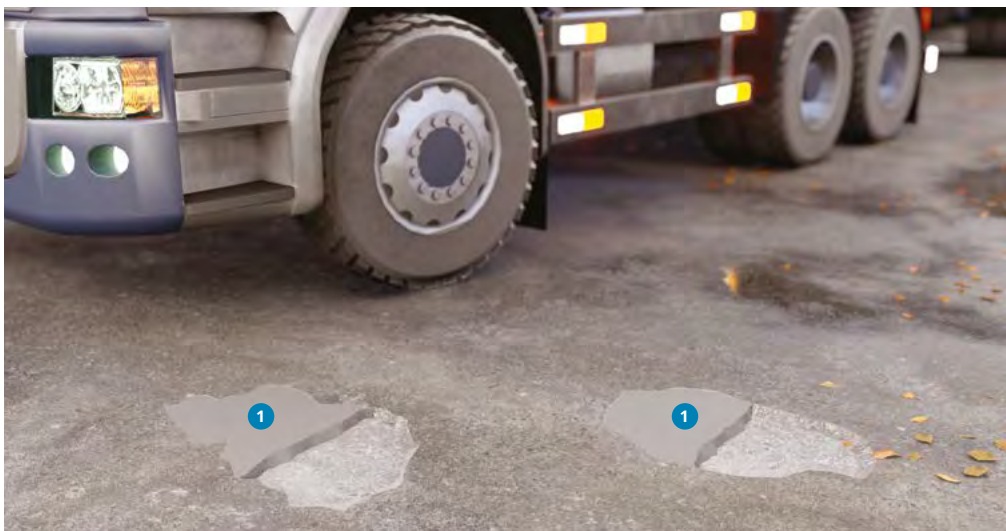

1 Concrete repair

KÖSTER Turbo Mortar F
KÖSTER Turbo Mortar M

Concrete Protection Systems

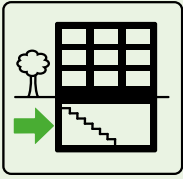

Concrete structures are subjected to a wide variety of damaging influences, both mechanical and chemical. Chemicals can directly attack the concrete matrix or dissolve in water and so enter the concrete and induce damage. To keep the structure safe, KÖSTER manufactures a wide variety of materials for the waterproofing and chemical protection of concrete. From hydrophobizing agents, to coatings for concrete and steel, and paints, KÖSTER can provide the proper solution for every problem.

Heavy duty corrosion protection for concrete

- 1 **Waterproofing layer**
KÖSTER NB 1 Grey
- 2 **Heavy duty surface protection**
KÖSTER PSM

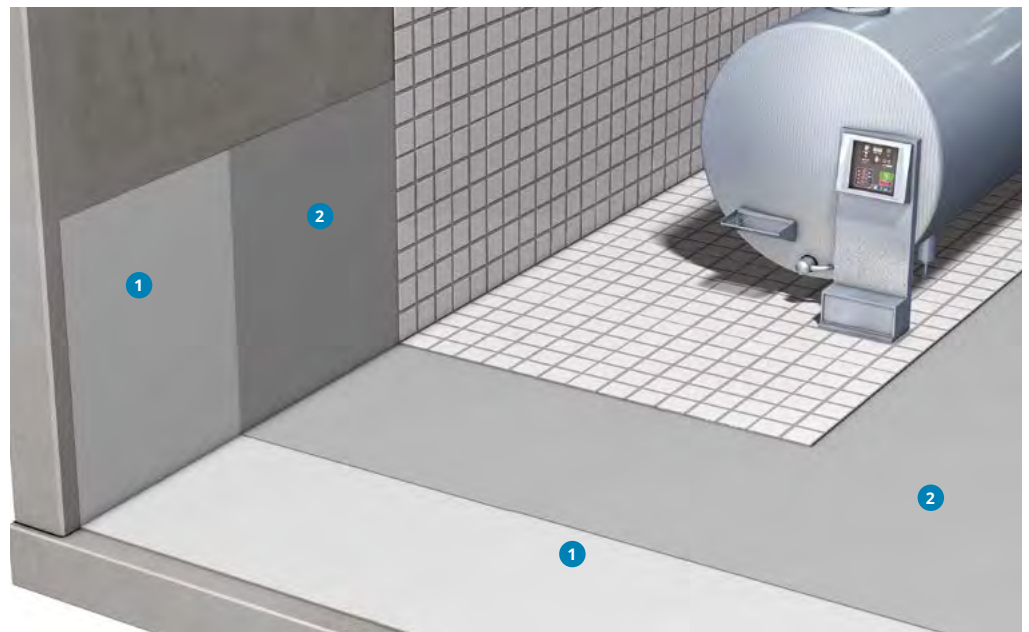

Heavy duty acid & corrosion protection for chimneys

- 1 **Reprofiling**
KÖSTER Repair Mortar NC
- 2 **Surface protection**
KÖSTER NB 1 Grey
- 3 **Area protection**
KÖSTER PSM
- 4 **Surface protection**
KÖSTER PSM 2S+
- 5 **Surface levelling and smoothing**
KÖSTER C-Coat
- 6 **Paint**
KÖSTER Renovation Paint White



Concrete protection of dams and spillways

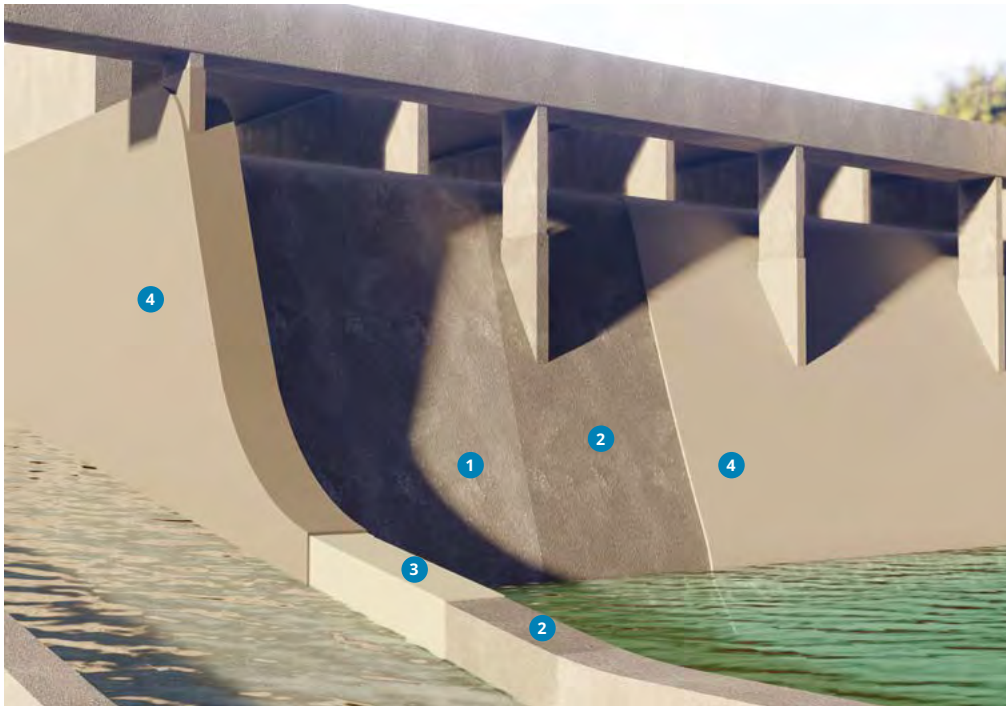

- 1 Substrate
- 2 Primer
KÖSTER Polysil TG 500
- 3 Surface protection
KÖSTER Repair Mortar R4
- 4 Waterproofing layer
KÖSTER NB 1 Grey
Alternative:
KÖSTER NB 1 Flex

Waterproofing Sewers and Shafts



- 1 Primer
KÖSTER Polysil TG 500
- 2 Levelling the substrate
KÖSTER Sewer
and Shaft Mortar
- 3 Surface protection against
abrasion and chemicals
KÖSTER Sewer
and Shaft Mortar

Self leveling underlayments

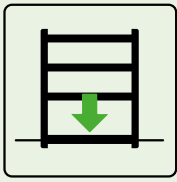

Whether installing flooring systems and coatings in new or existing buildings, substrates generally must first be levelled. The goal is to provide a level and highly resilient surface suitable for a broad variety of flooring systems.

Fast-setting self-leveling underlayment on mineral and non-absorbent substrates

- 1 Primer
KÖSTER VAP I 06
- 2 Floor coating
KÖSTER SL Premium



Self-leveling underlayment on wooden substrates

- 1 Primer
KÖSTER VAP I 06
- 2 Floor coating
KÖSTER SL Flex



Self-leveling protective floor with high chemical resistance

- 1 Primer
KÖSTER SL Primer
- 2 Floor coating
KÖSTER SL Protect

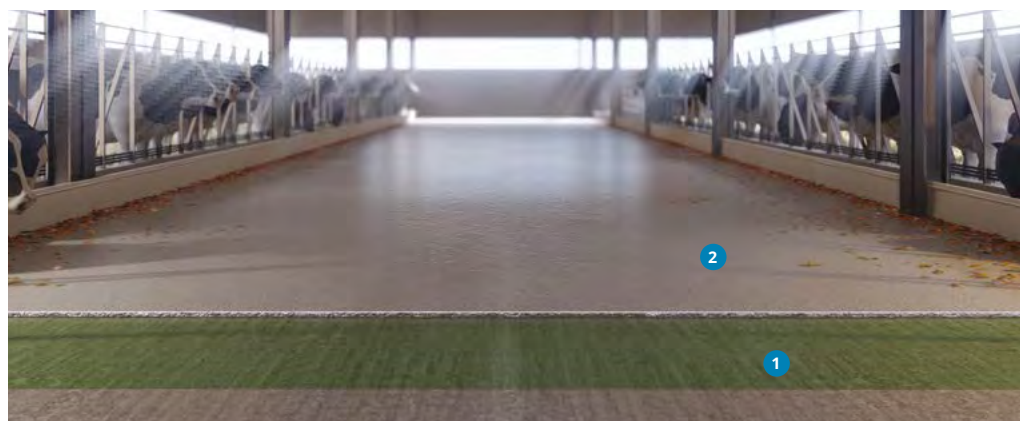

Highly flowable floor levelling for the subsequent installation of various floor coverings

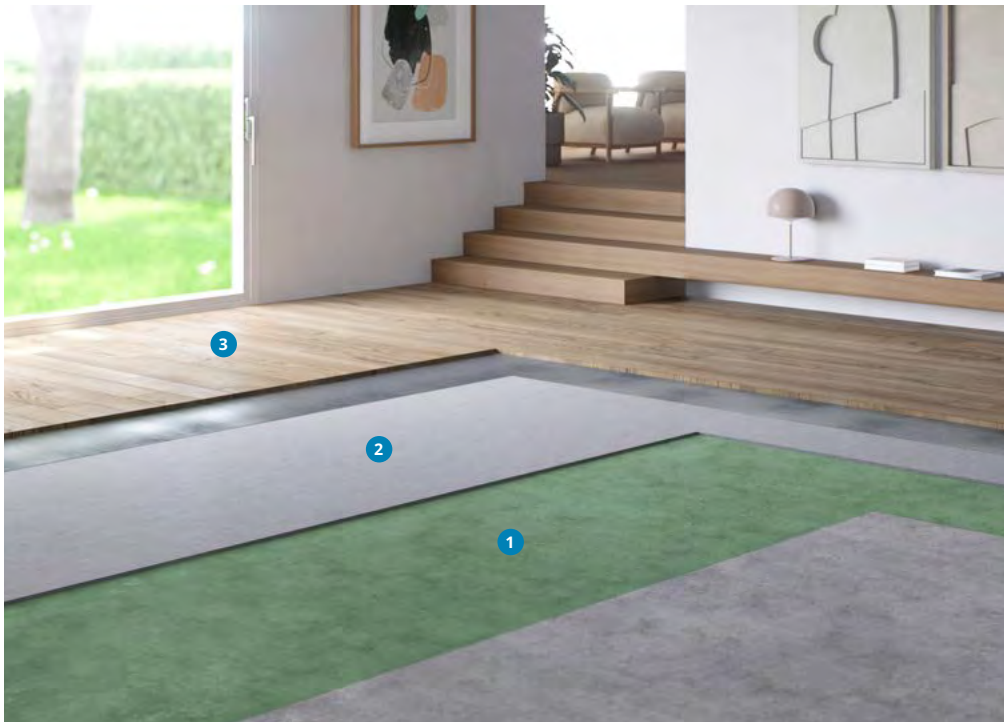

- 1 Primer
KÖSTER SL Primer
- 2 Floor coating
KÖSTER SL
- 3 Floor covering

Levelling for floor areas exposed to moisture



- 1 Concrete
- 2 Shot blasted concrete
- 3 Vapor barrier coating
KÖSTER VAP I 2000
- 4 Primer
KÖSTER VAP I 06
- 5 Self leveling underlayment
KÖSTER SL Premium
- 6 Floor covering

Flexible floor levelling on elastic waterproofing with KÖSTER NB 4000

- 1 Concrete Slab
- 2 Primer
KÖSTER Polysil TG 500
- 3 Rigid waterproofing layer
KÖSTER NB 1 Grey
Alternative:
KÖSTER NB 1 Flex
- 4 Flexible waterproofing layer
KÖSTER NB 4000
- 5 Self leveling underlayment
KÖSTER SL Flex
- 6 Floor coating
KÖSTER CT 215 Universal Floor

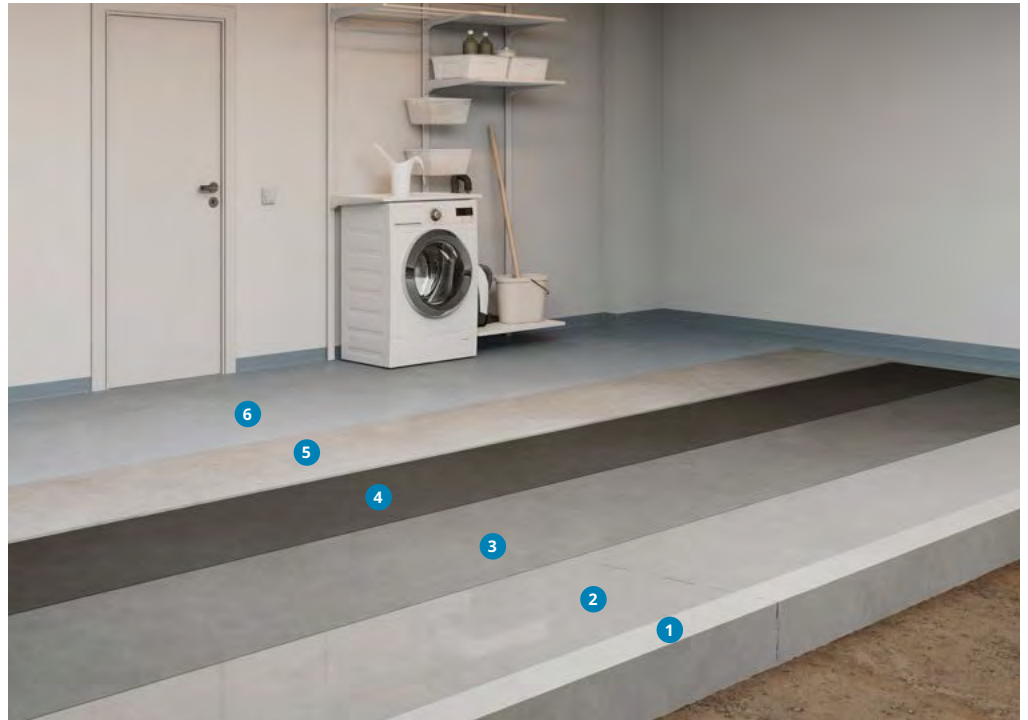

Floor levelling with KÖSTER SL Premium on rigid negative side waterproofing

- 1 Concrete slab
- 2 Primer
KÖSTER Polysil TG 500
- 3 Rigid waterproofing layer
KÖSTER NB 1 Grey
Alternative:
KÖSTER NB 1 Flex
- 4 Floor coating
KÖSTER SL Premium
- 5 Tile adhesive
KÖSTER BD Flexible Tile Adhesive



Floor coatings

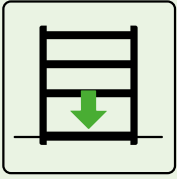

Floor coatings, for example on garages, industrial floors or canteen kitchens usually demand high standards on their resistance, as well as their visual appearance. These floors can be permanently protected against mechanical damage and the penetration of liquids with colored protective coatings.

Moisture Mitigation System

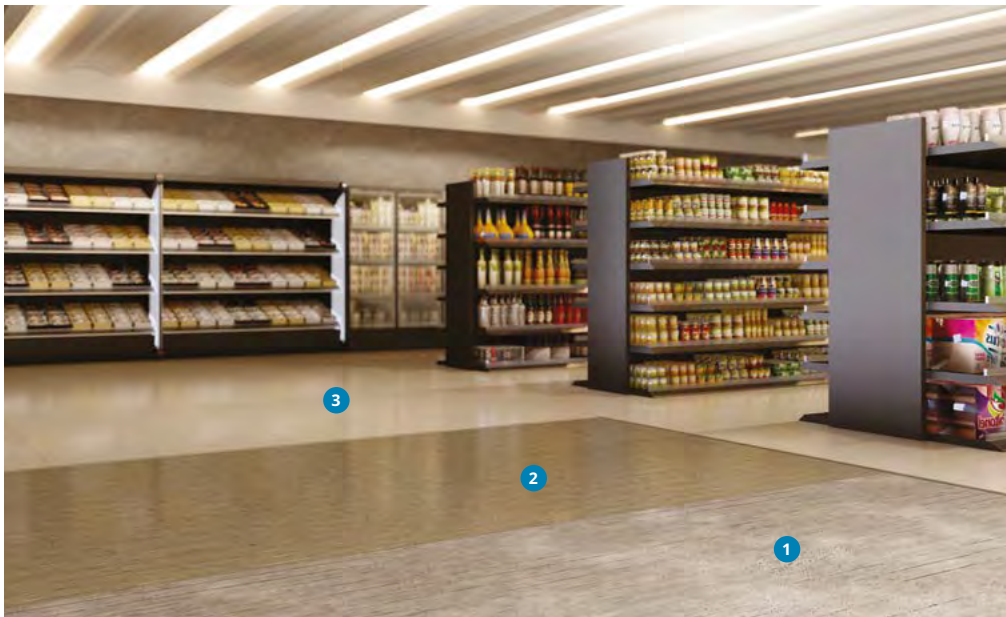

- 1 Moist concrete with high alkalinity
- 2 Vapour barrier
KÖSTER VAP I 2000
- 3 Floor coating
KÖSTER LF-VL

Floor coatings for balconies, terraces, commercial and private areas

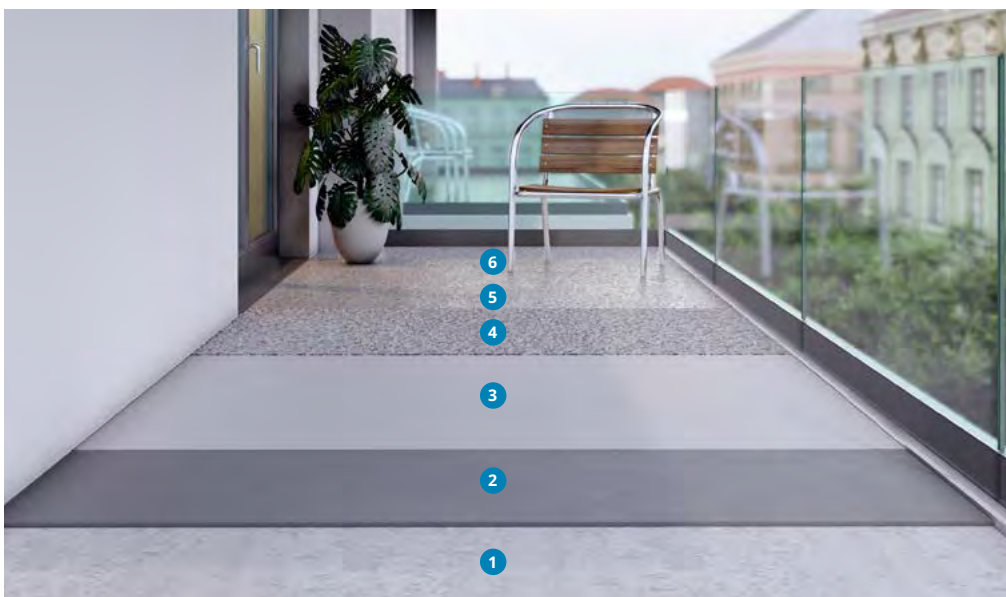

- 1 Substrate
- 2 Levelling
KÖSTER SL Protect
- 3 Floor coating
KÖSTER CT 227 1C Silane
- 4 Decorative layer
KÖSTER Color-Chips
- 5 Broadcast fixation
KÖSTER CT 327 1C Sealer
- 6 Protection
KÖSTER Top Coat 1C Matte

Floor coatings which are exposed to moderate stresses

- 1 **Primer**
KÖSTER CT 215
Universal Floor
- 2 **Floor coating**
KÖSTER CT 215
Universal Floor
- 3 **Surface protection (wall)**
KÖSTER Renovation
Paint White

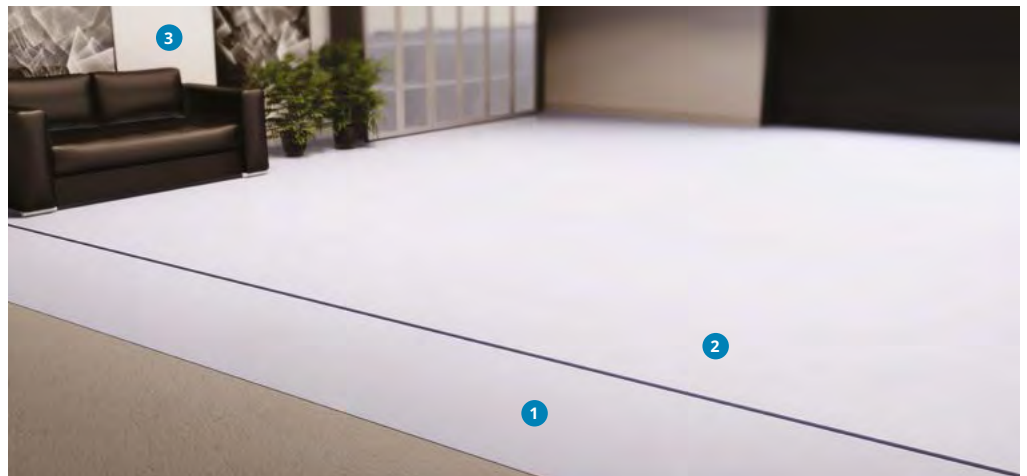

- 1 **Substrate**
- 2 **Primer**
KÖSTER CT 215
Universal Floor
- 3 **Floor coating**
KÖSTER CT 215
Universal Floor
- 4 **Decorative layer**
KÖSTER Color-Chips
- 5 **Protection**
KÖSTER TS transparent
- 6 **Surface protection (wall)**
KÖSTER Renovation Paint
White

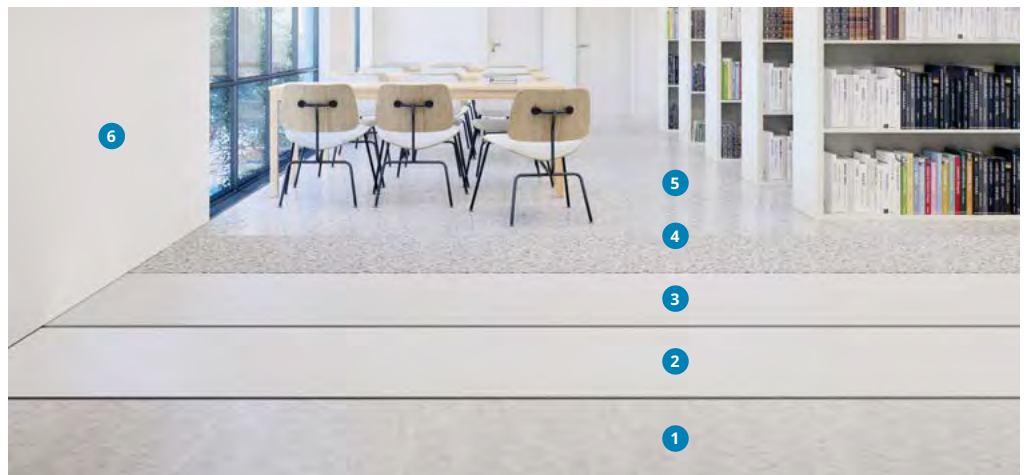

Floor coatings which are exposed to heavy stresses

- 1 **Substrate**
- 2 **Primer**
KÖSTER CT 121
- 3 **Slip resistance (optional)**
Quartz Sand
- 4 **Floor coating**
KÖSTER LF-VL

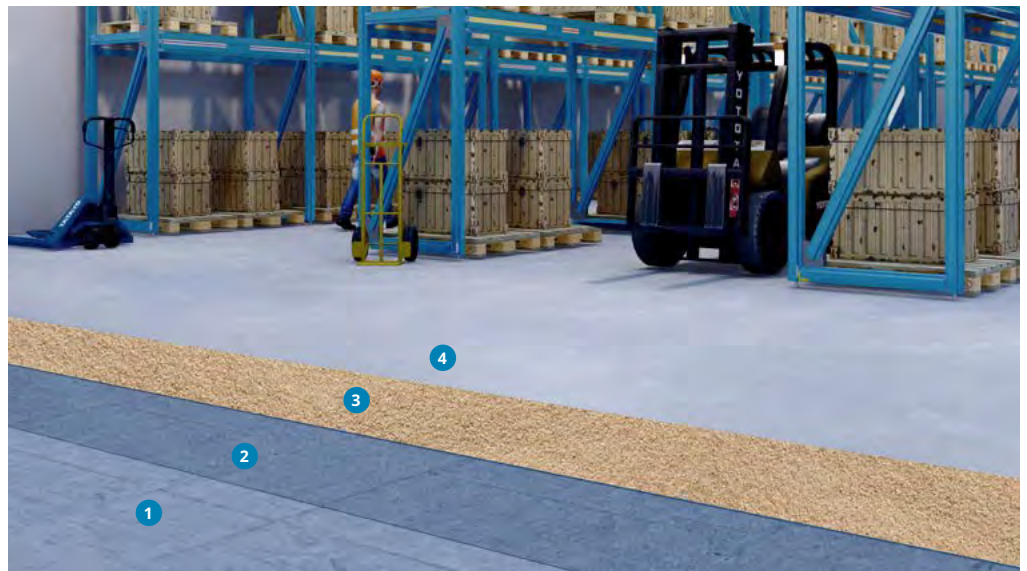

ESD Flooring System (electrostatic discharge)

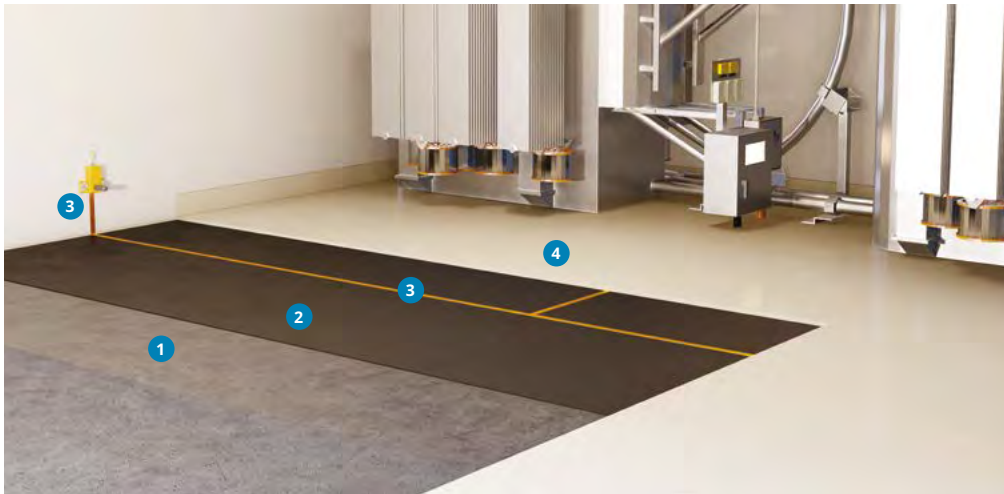

- 1 **Primer**
KÖSTER CT 121
- 2 **Conductive Coating**
KÖSTER ESD 175
- 3 **Ground**
KÖSTER ESD 476
- 4 **Top Coat**
KÖSTER ESD 275

Parking garages and trafficked surfaces with high mechanical stresses with the KÖSTER OS 8 System

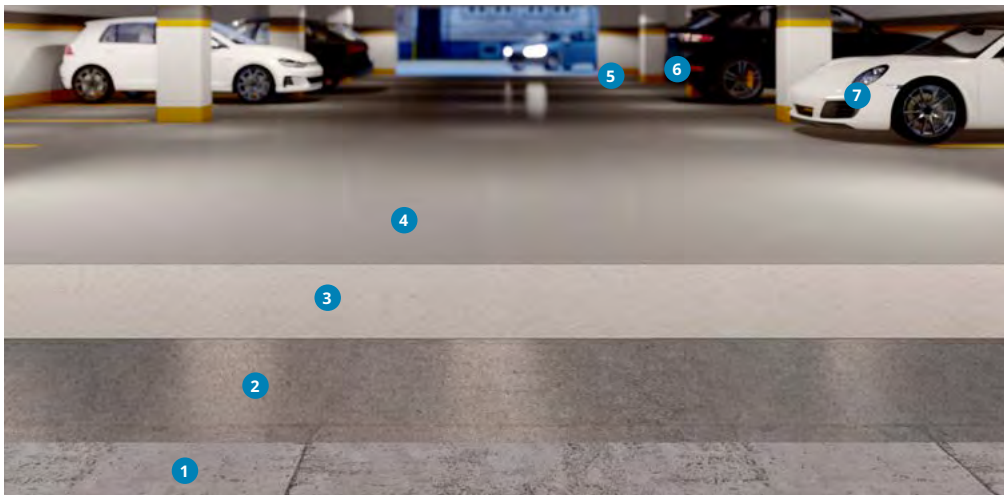

- 1 **Substrate**
- 2 **Primer**
KÖSTER CT 121
Quartz Sand 0.06 - 0.36 mm
- 3 **Broadcast**
Quartz Sand 0.4 - 0.8 mm
- 4 **Top Coat**
KÖSTER CT 221

Hygienic protective coating for the food production industry



- 1 **Substrate**
- 2 **Floor coating and underlayment**
KÖSTER UC 100
- 3 **Top coat**
KÖSTER UC 300
(also used as a primer)

Heavy chemical and mechanical protection with KÖSTER CT 228

- 1 Substrate
- 2 Cleaned Substrate
- 3 Primer
KÖSTER CT 121
- 4 Rigid waterproofing layer
KÖSTER CT 228 Flex



Corrosion protection

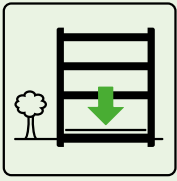

Corrosion protection is of primary concern, particularly in the industry and agriculture sectors, where there is a variety of areas with increased requirements; for example, such as high resistance against acids and alkalis.

In order to guarantee a long service life floor in production areas, warehouses or surfaces in tanks, they must all be protected with long-term solutions. KÖSTER provides systems for the effective protection of mineral substrates as well as steel surfaces.

Corrosion protection of steel



1 Corrosion protection

KÖSTER Corrosion Protection

2 Corrosion protection (crack bridging)

KÖSTER CT 228 Flex

Protection system for cooling towers



1 Gritblasted concrete

2 Waterproofing layer

KÖSTER NB 1 Grey

3 Protection of the Waterproofing layer

KÖSTER TG 500 2C

4 Gritblasted concrete

5 Waterproofing layer

KÖSTER NB 1 Grey

Alternative:

KÖSTER NB 1 Flex

6 Painting

KÖSTER Acrylic Paint

Joint sealing

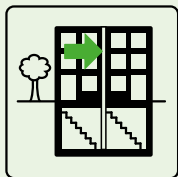

Joints in construction members are necessary to accommodate movements between them. Sealing these joints safely, means to seal them permanently elastic, form stable and UV-resistant. This allows for future movements of the construction members without causing damages.

1 Primer

KÖSTER FS Primer 2C

2 Vertical joints

KÖSTER Joint Sealant FS-V

3 Horizontal Joints

KÖSTER Joint Sealant FS-H

Joint sealing on mineral and metal surfaces with joint sealants based in polysulphide

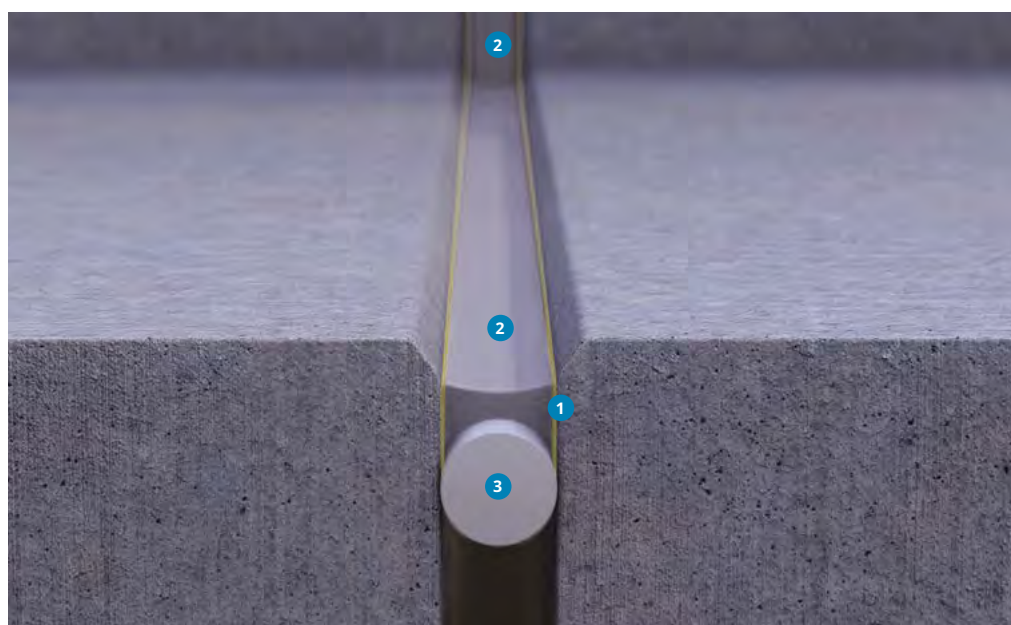

Joint sealing on dilatation joints and other moving joints with joint tapes

1 Primer

KÖSTER KB-Pox Adhesive

2 Joint sealing

KÖSTER Joint Tape

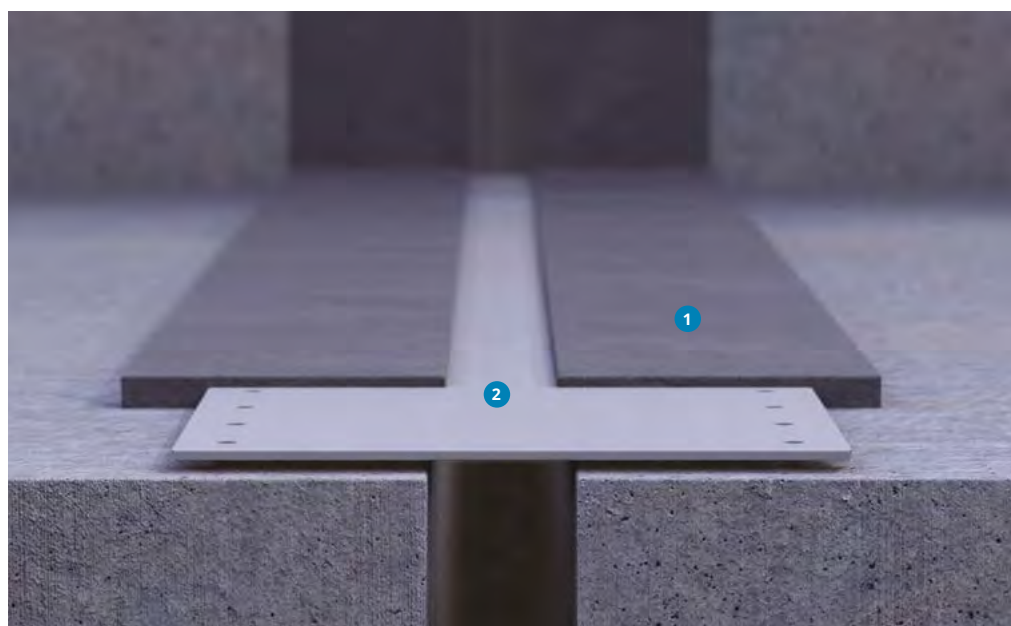

Waterproofing of cable and pipe penetrations



- 1 Penetration
- 2 Backing
- 3 Waterproofing
KÖSTER KB-Flex 200
- 4 Protection layer
KÖSTER KB-Fix 5

Joint sealing of construction and structural joints based on MS polymers

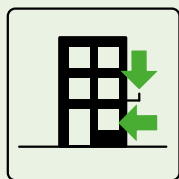

Joints in building components allow for movement and settlement, preventing cracks and damage. They absorb structural movements and create secure connections. Flexible, waterproof seals thus ensure the durability and functionality of the structure.

Joint sealing building components

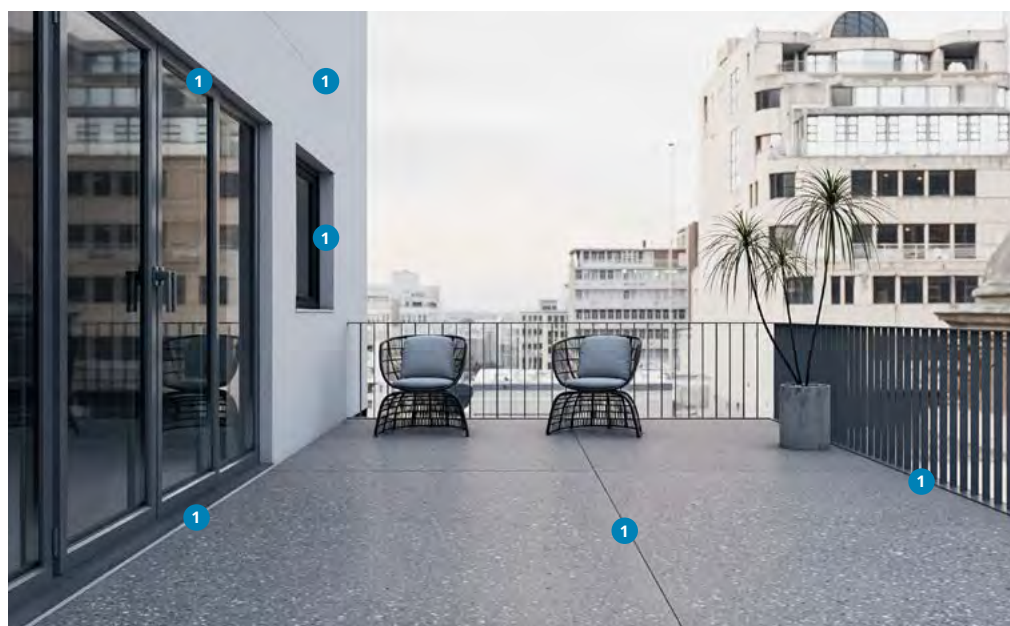

- 1 Joint sealing
KÖSTER MS Joint Sealant

Wet room waterproofing

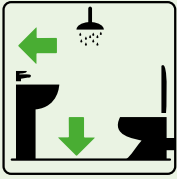

In these sensitive parts of the building, moisture can lead to severe damage to the entire building. Discoloration and tiles which are falling off the substrate are the first visible signs of such damages. Such rooms are waterproofed completely, in order to protect the substance of the structure. The entire wall and floor areas are seamlessly waterproofed. Seamlessly waterproofed with a system able to bridge possible cracks.

Wet room waterproofing with liquid synthetics

- 1 **Primer**
KÖSTER BD 50 Primer
- 2 **Waterproofing corners and wall floor junctions**
KÖSTER BD Flex Tape K 120
- 3 **Waterproofing outside corners**
KÖSTER BD Outside Corner
- 4 **Waterproofing inside corners**
KÖSTER BD Inside Corner
- 5 **Waterproofing wall penetrations**
KÖSTER BD Wall Sleeve
- 6 **Waterproofing floor drains**
KÖSTER BD Floor Sleeve
- 7 **Waterproofing layer**
KÖSTER BD 50
- 8 **Tile adhesive**
KÖSTER BD Flexible Tile Adhesive



Façade protection

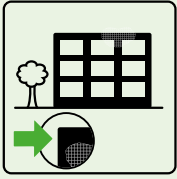

Climatic influences and the resulting penetration of moisture into the substrate often lead to damages to the façade. In order to protect façades made of mineral building materials, impregnations are used to make the surface water repellent. These hydrophobic agents penetrate deeply into the substrate, and dry without leaving residues, so that the visual appearance of the façade is not affected by the impregnation.

Protecting façades made of mineral building materials



1 Surface protection

KÖSTER Façade Cream

Alternative:

KÖSTER Siloxan

Protecting concrete surfaces on bridges and aqueous environments

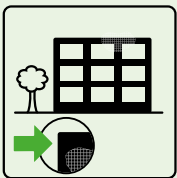

Exterior concrete structures such as bridges, highways, supporting walls, stadium columns, etc., are exposed to environmental conditions such as driving rain, contaminants and salts, that when dissolved in water, may enter the structure and cause deterioration of the concrete substance. A hydrophobization of the structure will reduce the water intake, protecting the structure from corrosion and prolonging its lifespan.

Protecting concrete surfaces on bridges and aqueous environments



1 Surface protection

KÖSTER Iperlan

Roof waterproofing with membranes

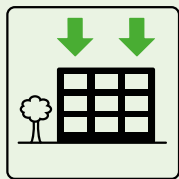

Roofs are the most stressed part of a building. The roofing membrane is exposed to a diversity of agents that accelerate the degradation of the material. Sunlight, UV radiation, wind, pollution, snow and frost, temperature fluctuations, hail and lightning storms are only a few of the big list of influences that the membrane is exposed on a flat roof. Also the huge diversity of equipments (AC, chimneys, etc) that are normally installed on flat roofs, can easily promote the premature aging of the materials and reduce its lifespan.

Therefore, the roofing membranes need to be highly resistant and have a lasting life protecting the roof without interfering with the environment.

Roof waterproofing with mechanically fastened membranes

- 1 Substructure
- 2 Vapor Barrier
- Vapor Barrier FR
- 3 Insulation
- 4 KÖSTER TPO Membrane
- KÖSTER TPO 1.2/1.5/1.8/2.0
- KÖSTER TPO Pro 1.2/1.5/1.8
- KÖSTER TPO FR 1.5/1.8/2.0
- 5 Mechanical fasteners

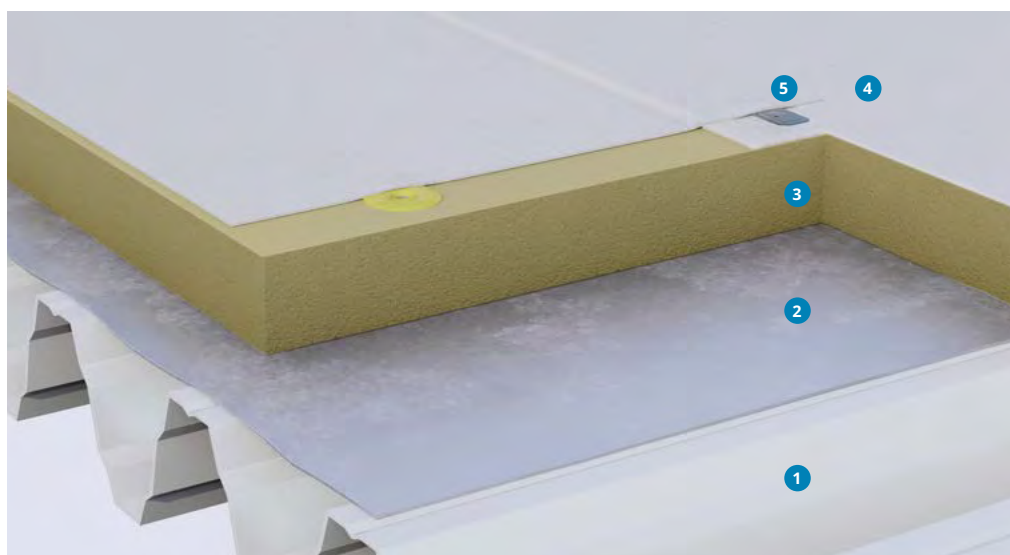

Roof waterproofing with bonded membranes

- 1 Substructure
- 2 Insulation
- 3 KÖSTER TPO Membrane
- KÖSTER TPO 1.5 F
- KÖSTER TPO 2.0 F
- 4 Adhesive
- KÖSTER PUR
- Membrane Adhesive

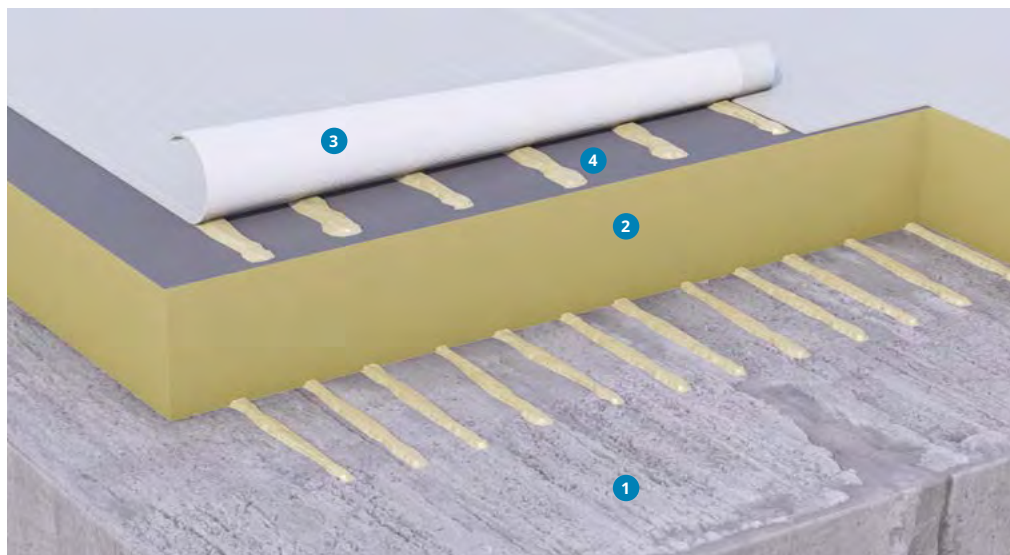

Roof waterproofing with loose-laid membranes

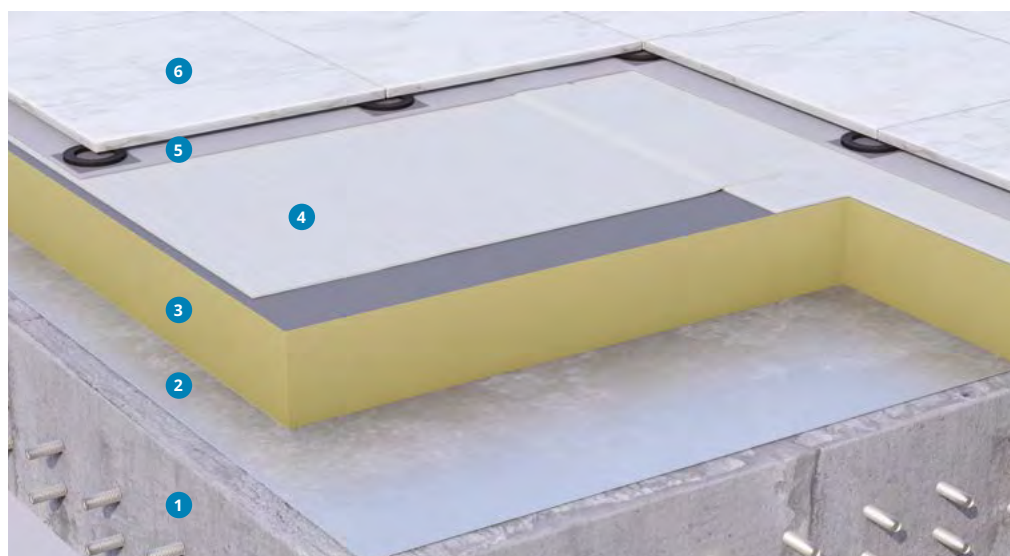

- ① Substructure
- ② Vapor Barrier
Vapor Barrier FR
- ③ Insulation
- ④ KÖSTER TPO Membrane
KÖSTER TPO 1.2/1.5/1.8/2.0
KÖSTER TPO Pro 1.2/1.5/1.8
KÖSTER TPO FR 1.5/1.8/2.0
- ⑤ Protection Layer
- ⑥ Ballast System



Roof waterproofing with self-adhered membranes

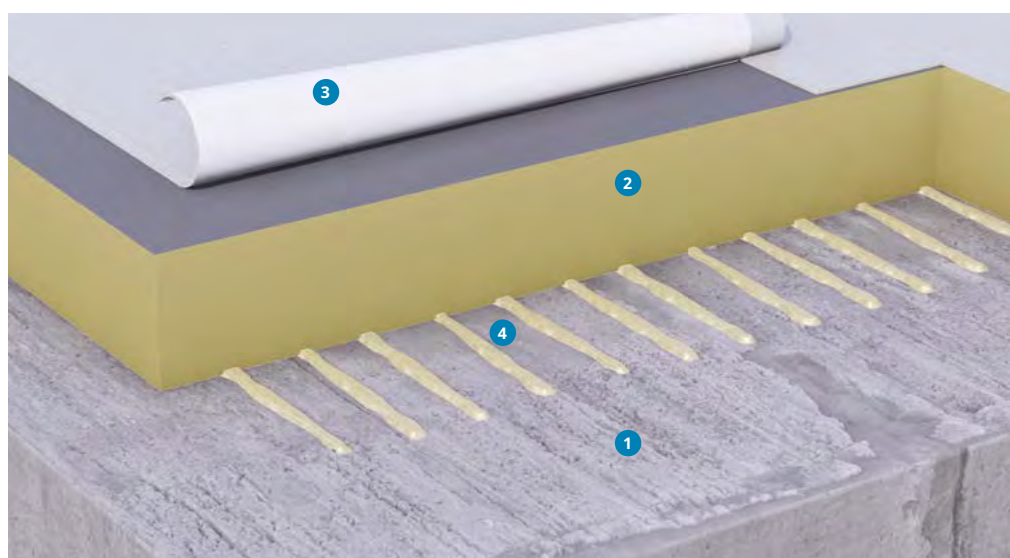

- ① Substructure
- ② Insulation
- ③ KÖSTER TPO Membrane
KÖSTER TPO 1.5 SK (FR)
KÖSTER TPO 2.0 SK (FR)
- ④ Adhesive
KÖSTER PUR
Membrane Adhesive

Roof waterproofing on green roofs

- 1 Substructure
- 2 Vapor Barrier
Vapor Barrier FR
- 3 Insulation
- 4 KÖSTER TPO Membrane
KÖSTER TPO 1.8/2.0
- 5 Protection Layer
- 6 Drainage Sheet
KÖSTER SD 3-250
- 7 Protection Layer
- 8 Ground / Greenery /
Landscaping

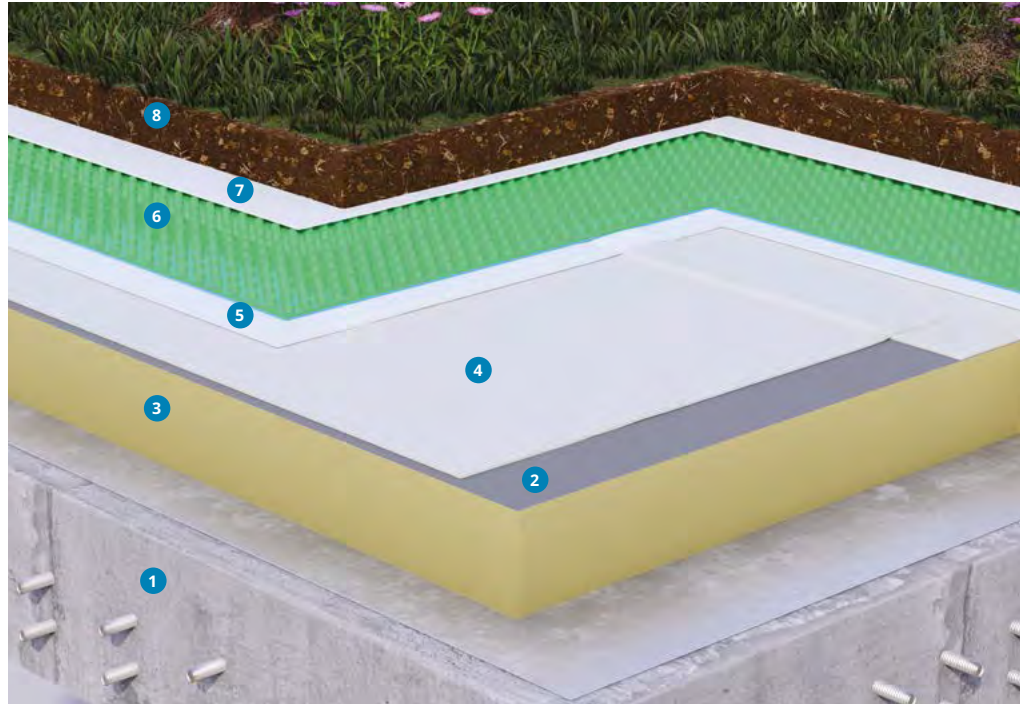

Flat roof waterproofing with liquid resin

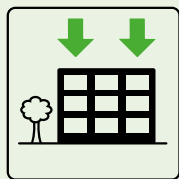

Concrete roofs are often difficult to waterproof with membranes due to numerous penetrations and complex geometry. KÖSTER has developed several liquid applied elastic waterproofing systems for roofs based on different types of technologies from the mineral base material to the MS polymer technology. Any of the options available are directly applied onto the prepared concrete substrate by roller, brush or spraying.

Roof waterproofing with MS polymer liquid resin



- 1 **Concrete Repair**
KÖSTER Betomor Multi A
- 2 **Primer**
KÖSTER CT 121
- 3 **Installing fillets**
KÖSTER WP Mortar
- 4 **Waterproofing wall / floor junctions**
KÖSTER Superfleece
- 5 **Waterproofing layer**
KÖSTER MS-Flexfolie

Waterproofing of sloped non accessible roofs



- 1 **Concrete Repair**
KÖSTER Betomor Multi A
- 2 **Primer**
KÖSTER Polysil TG 500
- 3 **Installing fillets**
KÖSTER WP Mortar
- 4 **Waterproofing wall / floor junctions**
KÖSTER Superfleece
- 5 **Waterproofing layer**
KÖSTER Dachflex
- 6 **Reinforcement**
KÖSTER Flex Fabric

WATERPROOFING SYSTEMS

Primer

KÖSTER Bitumen Primer	Solvent-containing bitumen primer
KÖSTER Primer BL	Solvent-free, highly adhesive primer for KÖSTER KSK waterproofing membranes and diluted as a primer for KÖSTER Bikuthan 1K

Sealing

KÖSTER MS-Flexfolie	Very easy to apply, one component, fast curing, highly elastic, UV resistant waterproofing with very good adhesion to numerous substrates
KÖSTER 21	White, two component, solvent free, multiple use crack bridging waterproofing, resistant to pressurized water, oil resistant
KÖSTER KD 1 Base	Fast setting sealing slurry. System component 1 of the KÖSTER KD System
KÖSTER KD-System	Negative side waterproofing against pressurized water
KÖSTER NB 1 Grey	Mineral based, sulfate resistant waterproofing system for positive and negative side waterproofing against pressurized water
KÖSTER NB Elastic Grey	2 component, elastic mineral waterproofing for areas in danger of cracking. For concrete and masonry substrates. Resistant to pressurized water
KÖSTER NB 4000	Two component, crack bridging, polymer modified thick film mineral waterproofing. Quickly rainproof, can be plastered over and radon-proof
KÖSTER KBE Liquid Film	Highly elastic, solvent-free, rubber/bitumen liquid membrane
KÖSTER Bikuthan 2C	2 component polymer modified bitumen thick film sealant with polystyrene light fillers for waterproofing building structures according to DIN 18533
KÖSTER Deuxan 2C	Crack-bridging, robust, 2 component polymer modified bitumen thick film sealant (PMBC) for waterproofing construction members according to DIN 18533
KÖSTER Dachflex	Solvent-free synthetic coating
KÖSTER KD 3 Sealer	Low viscosity, deeply penetrating silicifying liquid hardener. System component 3 of the KÖSTER KD System

Reinforcement

KÖSTER Glass Fiber Mesh	Glass silk fabric for reinforcing waterproofing
KÖSTER Superfleece	High strength polyester nonwoven reinforcement fabric for liquid waterproofing products
KÖSTER Flex Fabric	Plastic fabric for reinforcing thin-layer waterproofing 1 m x 50 m

Waterproofing Mortar and Substrate Leveling

KÖSTER KD 2 Blitz Powder	Stops flowing water in seconds. Highly reactive powder with a very short reaction time. System component 2 of the KÖSTER KD System
KÖSTER Repair Mortar	Fillet, repair and water-repellent finishing mortar
KÖSTER Repair Mortar Plus	Fast setting, expanding repair mortar
KÖSTER WP Mortar	Watertight, trowel applicable and fiber reinforced fast setting mineral reprofiling mortar
KÖSTER Waterstop	Expanding, fast curing plugging mortar for sealing water leakages

Additive

KÖSTER SB Bonding Emulsion	Elasticizing synthetic-dispersion for universal use in mortars, plasters, sealing slurries, and concrete
KÖSTER NB 1 Flex	Liquid admixture for KÖSTER NB 1 Grey and KÖSTER NB 2 White
KÖSTER NB 4000 Spray Additive	Liquid additive for KÖSTER NB 4000 for improving sprayability as well as other application characteristics

Sealing Tape/Membrane

KÖSTER Butyl Fix-Tape Fleece	Cold self adhesive, fleece laminated butyl waterproofing tape for KÖSTER KSK membrane to plaster transitions, 1.5 mm x 150 mm
KÖSTER Fix-Tape 15 SY	Cold self-adhesive rubber/bitumen sealing tape, width: 200 mm
KÖSTER KSK SY 15	Cold self adhesive bitumen membrane with HDPE top foil (moisture barrier type A and ground water barrier type T) 1.5 mm x 1.05 m x 20 m, 21 m ²

Accessories

KÖSTER SD Protection and Drainage Sheet 3 - 250	Three-layer, high quality backfill protection and drainage sheet with high compressive strength for KÖSTER waterproofing of building structures, 2 m x 15 m, 30 m ²
KÖSTER Peristaltic Pump	Electric pump (230 volt) for spraying liquid and pasty sealing materials on a mineral, aqueous and bituminous basis

RESTORATION OF MASONRY

Primer, Substrate Preparation

KÖSTER Polysil TG 500	Deeply penetrating primer for damp and salt burdened substrates, immobilizes salts, consolidates sanding substrates
KÖSTER Restoration Plaster Key	Fast setting, grey coarse plaster key, can be quickly overworked
KÖSTER Hydrosilicate Adhesive SK	Adhesive and Spackle for KÖSTER Hydrosilicate Boards

Horizontal Barrier

KÖSTER Mautrol Liquid Sealant	Silicifying liquid for waterproofing against rising damp
KÖSTER Mautrol 2C	2-component injection liquid for subsequent installation of horizontal barriers and for strengthening and solidifying masonry
KÖSTER Mautrol Flex 2C	2-component injection liquid for subsequent installation of damp proof horizontal barriers
KÖSTER Crisin Cream	Solvent free resin/silane injection cream against rising damp, 600 ml foil bag
KÖSTER Crisin 76	Concentrated, solvent free synthetic resin against capillary rising moisture in walls, independent of moisture content and salt contamination
KÖSTER Crisin 76 Cartridge	Concentrated, solvent free synthetic resin against capillary rising moisture in walls, independent of moisture content and salt contamination, 200 ml cartridge

Plasters, Panels

KÖSTER Fine Plaster	Fine plaster, area spackle, and base coat mortar in white
KÖSTER Restoration Spackle	Light grey fine plaster, surface filler and reinforcement mortar
KÖSTER Restoration Plaster Grey	Salt- and moisture resistant restoration plaster for inside and outside use
KÖSTER Restoration Plaster White	White salt- and moisture resistant restoration plaster for inside and outside use for manual or machine application
KÖSTER Restoration Plaster White/Fast	Fast setting, white, salt- and moisture resistant restoration plaster for inside and outside use
KÖSTER Restoration Plaster White/Light	White, light weight restoration plaster for salt- and moisture damaged masonry for hand or spray application for hand and machine application
KÖSTER Restoration Plaster Grey/Light	Grey, light, salt-resistant restoration plaster for the repair of moisture and salt burdened substrates for hand and machine application
KÖSTER Hydrosilicate Board	Mineral hydrosilicate tile system for mold remediation and prevention on interior surfaces
KÖSTER Thermal Restoration Plaster	Restoration plaster, thermal insulation plaster, and anti-mold plaster

Accessories

KÖSTER Suction Angle	Plastic angle for the pressureless and material saving installation of horizontal barriers against rising damp (wicking moisture) with the KÖSTER Suction Angle System. Re-usable
KÖSTER Capillary Rods	Patented injection wick for the uniform distribution of KÖSTER Mautrol Liquid Sealant and KÖSTER Crisin 76

INJECTION SYSTEMS

Injection Material

KÖSTER 2 IN 1	Water reactive elastic PU-injection resin for single and two stage injection of dry and water bearing cracks
KÖSTER IN 2	Elastic 2 component polyurethane injection resin
KÖSTER KB-Pox IN	Epoxy resin for crack injection and saturation for structural rebonding
KÖSTER IN 5	Elastic, low viscosity 2 component polyurethane injection resin for crack- and hose-injection
KÖSTER IN 8	Water-reactive, viscoelastic 1C PU injection foam for single and multiple step waterproofing of water-bearing cracks and joints
KÖSTER IN 8 Accelerator	Accelerator for KÖSTER IN 8 injection foam, 0,5 kg bottle
KÖSTER PUR Gel	Water activated polyurethane gel for area injections as well as for waterproofing expansion and dilation joints
KÖSTER Injection Gel G4	Low viscosity acrylic gel for curtain injection and injection into masonry and concrete
KÖSTER Injection Gel S4	Acrylic gel for stopping active water ingress, joint, and curtain injection with adjustable reaction time
KÖSTER Micro Grout 1C	Non-shrinking injection grout for crack and void filling with high final compressive strength

Sealing Mortar

KÖSTER Injection Barrier	Ultra fast curing cementitious barrier with high early strength to seal mineral surfaces injection of areas e.g. with KÖSTER Injection Gel G4
--------------------------	---

Accessories

KÖSTER PUR Cleaner	Organic cleaning agent for unreacted polyurethane resins
KÖSTER Impact Packer 12	Plastic packer with cone-head fitting and non-return valve for low-pressure injection used in horizontal barriers with KÖSTER Mautrol 2C or KÖSTER Mautrol Flex 2C
KÖSTER Superpacker 10 x 115 mm	Injection Packer for KÖSTER Injection Resins, Injection Gels, and Mautrol 2C (10 x 115 mm)
KÖSTER Packer 13 x 115 mm KN	Injection Packer for KÖSTER Injection Resins, Injection Gels, and Mautrol 2C
KÖSTER One-day-site Packer 13 x 120 mm	Injection Packer for KÖSTER Injection Resins, Injection Gels, and Mautrol 2C (13 x 90/120 mm)
KÖSTER 1C Injection Pump	Electrical injection pump for injection of KÖSTER IN resins and installation of horizontal barriers with KÖSTER Mautrol 2C and KÖSTER Mautrol Flex 2C
KÖSTER Acrylic Gel Pump	Stainless steel pneumatic pump for the application of the KÖSTER Injection Gel G4 and KÖSTER Injection Gel S4
KÖSTER Gel Packer (Base)	Impact packers for gel injection using pan-head fitting and non-return valves. With connection threads for an extension pipe. 18 mm x 115 mm
KÖSTER Gel Packer (End piece)	Patented end piece for gel packers with four sideways facing outlets for curtain injection (German patent 599 10 808.8, European patent No. 0 980 935). With connection threads for the KÖSTER Gel Packer Extension Pipe
KÖSTER Gel Packer extension pipe 800 mm	Extension pipe for KÖSTER Gel Packers. Length: 800 mm
KÖSTER Loka Hand Pump	Manually operated pump for pumping and injecting grouts
KÖSTER Hand Pump without manometer	For small injection projects or areas which are difficult to access
KÖSTER Hand Pump with manometer	For small injection projects or areas which are difficult to access
KÖSTER Resin Mixer, complete, 100 mm	Special mixer for resins
KÖSTER Resin Mixer, complete, 75 mm	Special mixer for resins
KÖSTER Universal Cleaner	Solvent-free cleaning agent for bituminous materials and epoxy resins

CONCRETE REPAIR AND PROTECTION

Corrosion Protection

KÖSTER Z1	Polymer modified, mineral corrosion protection coating
KÖSTER Z2	Polymer modified, mineral corrosion protection coating

Concrete Protection, Repair Mortar

KÖSTER PSM	High chemically resistant special mortar in the area of pH 0-8
KÖSTER PSM 2S+	One-component, chemically and thermally resistant coating for mineral surfaces in power plant construction
KÖSTER Betomor Multi A	Multi-functional filling, levelling, and corrosion protection mortar for the fast repair of concrete and masonry
KÖSTER C-Coat	Filling and levelling mortar as well as shrinkage or blow-hole filler for concrete surfaces
KÖSTER KB-Fix 5	Fast setting mortar for swift installations
KÖSTER Turbo Mortar F	Fine grained, fast setting repair and re-profiling mortar with very early high strength development
KÖSTER Turbo Mortar M	Fast setting, fiber reinforced repair and re-profiling mortar with very early high strength development
KÖSTER Repair Mortar NC	Fiber reinforced repair, concrete replacement and finishing mortar with high chemical and mechanical resilience
KÖSTER Repair Mortar R4	Concrete repair mortar with high chemical and mechanical resistance
KÖSTER Sewer and Shaft Mortar	Chemically resistant, fast curing restoration mortar for sewers and shafts

Additive

KÖSTER Turbo Binding Agent	Fast setting special binding agent for mortars with very high early strength development
KÖSTER Turbo Super Plasticizer	Super Plasticiser for the KÖSTER Turbo System
KÖSTER Turbo Retarding Agent	Additive for the KÖSTER Turbo System. For slowing the setting time of KÖSTER Turbo Mortars to meet individual jobsite requirements, 25 g bag
KÖSTER BDM Liquid	Triple action crystallizing integral waterproofing additive for concrete
KÖSTER BDM Powder	Triple action crystallizing integral waterproofing for concrete
KÖSTER Mortar Tight	Additive to mortars to create waterproof mortars and renders
KÖSTER Mortar Boost	Liquid synthetic additive to strongly improve technical features and workability of concrete and mortar systems. Liquid component for KÖSTER Injection Barrier. Additive for KÖSTER Turbo Mortar systems
KÖSTER Mortar Accelerator	Powder additive for accelerating the setting time of mortars

JOINT SEALING

Substrate Penetration, Primer

KÖSTER KB-Pox Adhesive	High performance epoxy adhesive
KÖSTER PU Primer 120	One component PU primer for non-porous surfaces, 250 ml can
KÖSTER FS Primer 2C	Bonding agent for KÖSTER Joint Sealant FS-V and FS-H for dry and moist substrates, 200 g combi package

Joint Sealing

KÖSTER Joint Sealant FS-V grey	Stiff / creamy 2 component polysulphide joint sealant
KÖSTER Joint Sealant FS-H grey	Self-levelling, elastic 2 component polysulphide joint sealant
KÖSTER MS Joint Sealant white	
KÖSTER MS Joint Sealant grey	
KÖSTER KB-Flex 200	Permanently plastic, damp and waterproof sealing compound for waterproofing against pressurized water, 850 g in 530 ml foilbags
KÖSTER Quellband	Sodium bentonite based water swellable joint tape
KÖSTER Joint Tape 20	Elastic sealing tape for waterproofing joints and irregular cracks 1 x 200 mm
KÖSTER Joint Tape 30	Elastic sealing tape for waterproofing joints and irregular cracks 1 x 300 mm

Accessories

KÖSTER Special Caulking Gun	Caulking gun for installing KÖSTER KB-Flex 200
KÖSTER Caulking Gun	For standard 310 ml cartridges and tubular bag up to 400 ml content

BATHROOM AND WET ROOMS

Primer

KÖSTER BD 50 Primer	Deeply penetrating bonding agent for waterproofing with the KÖSTER BD 50 System
---------------------	---

Self-Leveling Compounds, Grouting Mortar

KÖSTER BD 50	Solvent-free elastic waterproofing for damp- and wet rooms under tile
--------------	---

Accessories

KÖSTER BD Contrast	Liquid contrast agent for coloring KÖSTER BD 50, 500 g unit
KÖSTER BD Flexible Tile Adhesive	Single component mineral flexible adhesive for all mineral materials in construction
KÖSTER BD Flex Tape K 120	Highly flexible, rubber-like joint sealing tape, 0.6 x 120 mm
KÖSTER BD Inside Corner	Elastic formed part for permanent waterproofing of inside corners in combination with waterproofing systems under tile
KÖSTER BD Outside Corner	Elastic formed part for permanent waterproofing of outside corners in combination with waterproofing systems under tile
KÖSTER BD Wall Sleeve	Elastic formed part for permanent waterproofing of pipe penetrations in combination with waterproofing systems under tile
KÖSTER BD Floor Sleeve	Elastic formed part for permanent waterproofing of floor drains in combination with waterproofing systems under tile

SELF LEVELING UNDERLAYMENTS

Primer

KÖSTER VAP I 06	Primer for non-porous substrates
KÖSTER SL Primer	Deep penetrating primer for concrete and screed substrates in conjunction with KÖSTER SL floor leveling compounds

Self Leveling Compounds, Grouting Mortar

KÖSTER VGM Fast	Ready to use, fast curing grouting mortar
KÖSTER VGM Swellable Grout	Swellable self-leveling grout
KÖSTER SL Premium	Fast hardening, self-levelling floor screed
KÖSTER SL	Fast hardening hydraulic, self-levelling interior floor screed
KÖSTER SL Flex	Flexible self-levelling underlayment for wood, and tiled substrates
KÖSTER SL Protect	Protective self-leveling floor with high chemical resistance

Accessories

Flow Test Board for Self Levelling Mortars	Flow test board for self levelling mortars (test cylinder included)
--	---

COATINGS

Primer

KÖSTER CT 121	Moisture tolerant, solvent-free epoxy primer, universal binder, and primer resin for the trafficable coating OS-8 System
KÖSTER ESD 175	Conductive layer for electrostatic discharge floors in combination with KÖSTER ESD 275 according to the ESD Guidelines

Coatings

KÖSTER CT 215 Universal Floor light Grey - standard colour-	Scratch-resistant primer and sealing coat for light to medium chemically and mechanically stressed wall and floor surfaces
KÖSTER CT 221	Self leveling floor coating for trafficable areas and coating layer for CT 121 in the KÖSTER OS-8 System
KÖSTER CT 225 Bridge Deck Coating	Priming and coating epoxy resin for concrete road sections, bridge decks, and civil engineering structures for overworking with mastic asphalt according to ZTV-ING (part 7)
KÖSTER CT 227 1-C-Silane - light grey	One component floor covering for light to medium exposure
KÖSTER CT 228 Flex	2-component, viscoplastic, brushable, rollable and sprayable epoxy resin for heavy-duty corrosion protection of concrete and steel surfaces
KÖSTER VAP I 2000	A system for the control of moisture and pH on concrete floors to avoid osmotic blistering
KÖSTER VAP I 2000 UFS	Ultra fast setting moisture vapor control system for the prevention of flooring failures such as osmotic blistering and delamination
KÖSTER UC 100	Self-leveling, abrasion resistant, chemically resistant polyurethane cement floor covering
KÖSTER UC 300	Solvent free top coat for KÖSTER UC 100 and primer for the KÖSTER UC System
KÖSTER ESD 275 light grey	KÖSTER ESD 275 is a rigid, solvent free, self leveling surface coating for floor areas which are to be protected by an ESD zone
KÖSTER Corrosion Protection	Brush, roller or spray applied 2 component solvent free coating for heavy corrosion protection for steel and concrete

Sealants

KÖSTER TS transparent	Transparent surface sealant, brushable, rollable, and sprayable
KÖSTER Top Coat 1C matte	Matte, transparent, one-component aqueous PU Sealant for broadcast or smooth coatings
KÖSTER CT 327 1-C-Sealer	One-component, flexible, UV and weather-resistant, solvent-free, transparent top sealer for light to medium mechanical and chemical loads

Additives, Fillers

KÖSTER Anti-Slip Granulate 20	Polymer granulate to increase slip resistance of top coating
KÖSTER Color-Chips (white, light grey, grey)	Decorative colored chips for broadcasting into e.g. KÖSTER CT 215 Universal Floor, KÖSTER CT 227 1C Silane, and other resin products
KÖSTER Filler Fine	Special filler for floor coatings resistant to mechanical stress
KÖSTER KB-Pox Thickening Agent	Thickening, thixotropizing agent for KÖSTER epoxy resins

Accessories

KÖSTER Screed Anchor 6 x 70 mm	Screed anchor (6 x 70 mm) for force transmitting filling of cracks in screed substrate
--------------------------------	--

FAÇADE PROTECTION AND PAINTS

Impregnation

KÖSTER Façade Cream	Water repellent impregnation cream for mineral substrates
KÖSTER Siloxan	Water repellent liquid façade waterproofing for mineral building materials
KÖSTER Iperlan	Highly effective hydrophobizing impregnation agent for concrete in civil engineering construction

Paint

KÖSTER Renovation Paint White	Silicone resin paint for painting exterior or interior, rendered and mineral-plaster covered surfaces
-------------------------------	---

ROOFING

FPO/TPO roofing and waterproofing membranes made from thermoplastic polyolefin, manufactured from high-quality polyethylene-based polymers with centrally embedded glass fleece reinforcement

Product Name	Colour	Thickness in mm	
KÖSTER TPO	Light Grey	1.2 1.5 1.8 2.0	Our proven premium TPO waterproofing membrane. Suitable for mechanical fastening, loose laying, and ballasted applications (e.g., gravel, green roofs).
KÖSTER TPO PRO	White	1.2 1.5 1.8	Our exceptionally eco-friendly TPO waterproofing membrane. Suitable for mechanical fastening, loose laying, and ballasted applications (e.g., gravel, green roofs). It offers high sustainability with proven CO ₂ emission reduction through the partial use of recycled polymers for environmentally friendly construction. The white color reflects sunlight, contributing to cooling.
KÖSTER TPO FR	White	1.5 1.8 2.0	The highly fire-resistant waterproofing membrane with FM approval (expected early 2025). Specifically designed to meet today's strictest fire protection standards for roofing.
KÖSTER TPO F	Light Grey	1.5 2.0	The fleece-backed KÖSTER TPO waterproofing membrane for adhered systems. Suitable for direct adhesion onto insulation boards or the substrate.
KÖSTER TPO SK	Light Grey	1.5 2.0	The quick-to-install, self-adhesive KÖSTER TPO. Featuring a polyester fleece backing with a self-adhesive layer, it is also suitable for direct application on EPS. This ensures immediate and lasting adhesion of the membrane, providing optimal protection against wind uplift forces.

KÖSTER TPO Aqua

Product Name	Colour	Thickness in mm	
KÖSTER TPO Aqua	Light Grey	1.5	The waterproofing membrane for use in drinking water applications. It meets all hygiene requirements for drinking water use according to DVGW Worksheet W270 and KTW recommendation.

KÖSTER TPO Aqua Geo

Product Name	Colour	Thickness in mm	
KÖSTER TPO Aqua Geo	Light Grey	2.5	The most robust KÖSTER TPO for use in hydraulic engineering, ideal for dams and water reservoirs. The KÖSTER TPO Aqua Geo is 2.5 mm thick and laminated with 500 g/m ² polyester fleece. This gives the membrane outstanding mechanical properties, making it ideally suited for long-lasting and reliable waterproofing solutions in hydraulic engineering.

Accessories

For the TPO waterproofing membranes, we offer a comprehensive accessory program covering every detail for a professional sealing solution.

This includes precision-fit inner and outer corners, flexible connection sleeves, high-quality composite sheets, roof drains, and much more.

Explore our accessory program for KÖSTER TPO roofing and waterproofing membranes to find everything you need for a fully reliable and long-lasting waterproofing solution.





We are there for you – worldwide.

Issued: 11/2024

// Contact us

KÖSTER BAUCHEMIE AG
Dieselstraße 1–10
D-26607 Aurich
Tel.: +49 4941 9709 0
E-Mail: info@koster.eu

www.koster.eu

Follow us on social media:



KÖSTER
Waterproofing Systems



DEUTSCHE
BAUCHEMIE



Always adhere to the specifications in the respective Technical Data Sheets.